

EPPS'S (GRATEFUL COMFORTING) COCOA.



C. CRUFT, Secretary,  
325, Holloway Road, LONDON.

SCHEDULE.

5<sup>TH</sup>

GREAT

TERRIER SHOW

Separate Entrance from  
Broad Sanctuary.



WEDNESDAY,  
THURSDAY, & FRIDAY,  
APRIL 3rd, 4th, and 5th,  
IN THE SPACIOUS  
ST. STEPHEN'S HALL,  
Royal Aquarium.



From ILLUSTRATED LONDON NEWS.

EPPS'S (GRATEFUL COMFORTING) COCOA.

Bassets  
 Bloodhounds  
 Bulldogs  
 Colleys  
 Dachshunds  
 Danes  
 Fox Terriers  
 Greyhounds  
 Mastiffs  
 Newfoundlands  
 Pointers  
 Pomeranians  
 Pugs  
 Retrievers  
 Setters  
 Spaniels  
 St. Bernards  
 Terriers  
 Toys

&c., &c.,

EASILY  
BOUGHT, SOLD,  
 or EXCHANGED  
 THROUGH  
**The Bazaar,**  
**Exchange and Mar**

*Articles on Dog Management, the  
 Various Breeds of Dogs, and other sub-  
 jects of interest to Dog Owners, are  
 frequently given.*

"That excellent but seductive journal."  
*Saturday Review.*

PRICE 2d., OF ALL NEWSAGENTS.

Office: 170, STRAND, LONDON.

FIFTH GREAT  
**TERRIER SHOW,**  
**ST. STEPHEN'S HALL,**  
 WESTMINSTER,  
**APRIL 3rd, 4th, & 5th 1889.**

PATRONS.

RIGHT HON. VISCOUNT MEVILLE  
 SIR WM. HEATHCOTE, BART.  
 SIR H. DE TRAFFORD, BART.  
 BARON HEATH  
 MAJOR-GENERAL RAINES, C.B.  
 CAPTAIN MOLESWORTH, R.N.  
 C. J. HENLEY, Esq.  
 C. G. CESWELL, Esq.  
 T. H. BOLTON, Esq.

KENNEL CLUB  
 FOX TERRIER CLUB.  
 SOUTHDOWN F. T. C.  
 SKYE TERRIER CLUB  
 WELSH TERRIER CLUB  
 YORKSHIRE TERRIER CLUB  
 SCOTTISH TERRIER CLUB  
 IRISH TERRIER CLUB  
 DANDIE DINMONT CLUB  
 BULL TERRIER CLUB  
 BLACK & TAN TERRIER CLUB

PRESIDENT.

SIR HUMPHREY F. DE TRAFFORD, BART.

VICE-PRESIDENTS.

MR. J. W. BERRIE, (PRESIDENT BULL TERRIER & BLACK & TAN TERRIER CLUBS).	REV. W. J. MELLOR, (Kennel Club)
MR. M. CAMPBELL, (Kennel Club)	MR. A. MAXWELL, (F.T.C.)
" F. M. CHATTERTON	" PERCY REID, (Kennel Club.)
" A. H. CLARKE, (F.T.C.)	" F. REDMOND, (Kennel Club.)
" F. H. FIELD, (F.T.C.)	" A. W. A. TAYLOR, (S.F.T.C.)
" H. A. GRAVES, (Kennel Club)	" J. C. TINNE, (Kennel Club)
" LINDSAY HOGG, (F.T.C.)	" W. T. TOMLINSON, (Black & Tan Terrier Club)
" A. C. JACKSON, (Kennel Club)	
" E. C. LONGMORE, (F.T.C.)	MR. R. VICARY, (Kennel Club).

COMMITTEE.

MR. L. P. C. ASTLEY	MR. A. MAXWELL
" J. W. BERRIE	" R. F. MAYHEW
" F. M. CHATTERTON	" J. PRATT
" J. FOSTER	" W. J. TOMLINSON
" C. LANE	" C. W. WHARTON

JUDGES.

MR. R. VICARY, Wire-Haired Fox Terriers, Irish Terriers.	MR. — MANUELLE, Black and Tans
" J. DOYLE, Smooth Fox Terriers	" T. BIRKLEY, Old English, Airedales and Yorkshires
" J. WILSON, Dandies	" J. BERRIE, Schipperkes and Bedlington
" L. P. C. ASTLEY, Scottish	REV. T. NOLAN, Skyes
" E. POWELL, jun., Welsh	
" A. GEORGE, Bull, White Eng- lish, Selling Classes	

TREASURER.

MANAGER, LONDON & COUNTY BANK, HOLLOWAY.

SECRETARY.

CHARLES CRUFT, 325, HOLLOWAY ROAD, LONDON, N.



EVERY FRIDAY, PRICE 2d.

EVERYBODY WHO KEEPS  
**DOGS,**  
**POULTRY,**  
**PIGEONS,**  
 OR  
**RABBITS**

SHOULD READ

**"THE STOCK-KEEPER."**

IT CONTAINS

THE FULLEST AND BEST REPORT OF ALL SHOWS.

"The Stock-keeper" is the Best Guide for Breeders and Exhibitors of Dogs, Poultry, Pigeons, &c. To be had of all Newsagents and Booksellers.

Offices—139 & 140, FLEET STREET, E.C.

1889

# SPRATT'S PATENT DOG SANATORIUM.

Under the personal supervision of Mr. A. J. SEWELL, M.R.C.V.S.

## THE PROGRESS OF VETERINARY SCIENCE AND SPRATT'S SANATORIUM.

(Reprinted from "The Stock-Keeper.")

In the first half of the present century, although eminent veterinaries like Blaine and Youat had written works on the medical-treatment of dogs, the care of man's most constant companion was left to practitioners who either were totally incapable or considered a dog too insignificant a patient to vouchsafe him their serious attention. Many veterinary surgeons thought it actually *infra dig.* to give dogs their professional care, and the majority of those who kept an "Infirmery for Dogs" might, without doing much violence to truth, have designated the wretched hovel set apart for that branch of their business an "*Infernary* for Dogs."

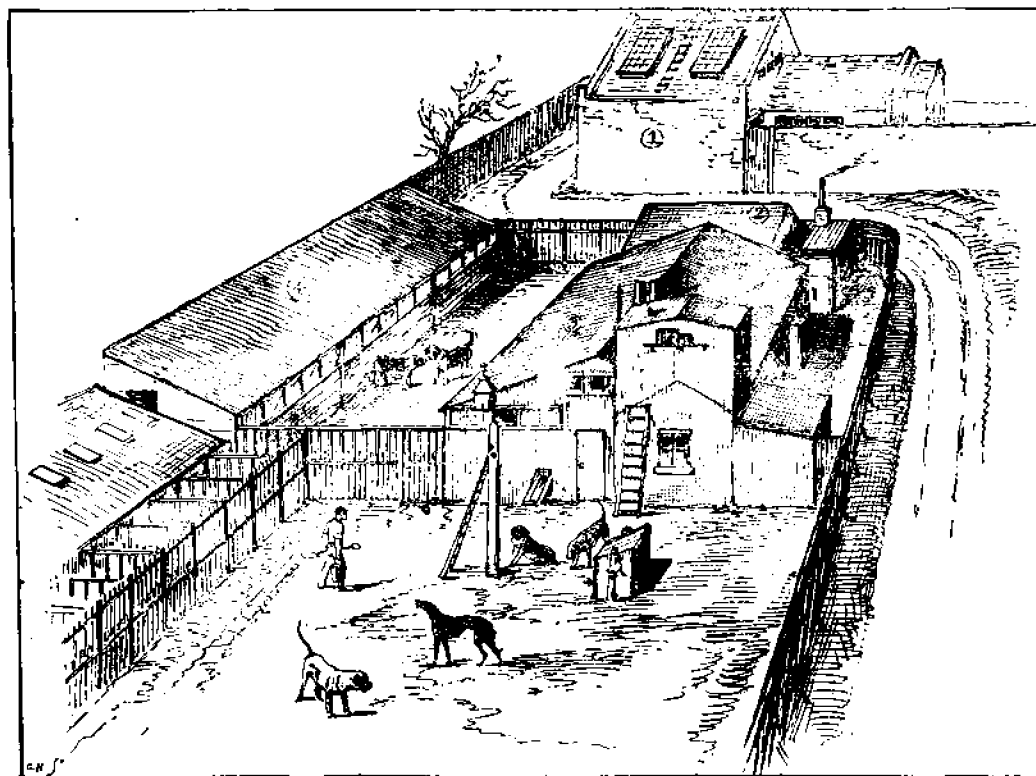

BIRD'S-EYE VIEW OF SPRATT'S SANATORIUM.

The medical treatment of the patients, which was generally left in the hands of one of the grooms, was extremely simple, and reminded one of the skipper who carried no surgeon on board his ship. When anything was the matter with one of

his sailors he would call him aft and let him strip. He then chalked a line round the patient's waist, and if the pain he felt was above the line he gave him an emetic, and if below, a purge.

During the last few years a great change has, however, taken place, and it is gratifying to be able to point to a picture of a more pleasing kind. In different parts of England dog hospitals have sprung up worthy of the name, and some of the veterinary surgeons have made dogs their special study. In the foremost rank amongst these gentlemen is Mr. A. J. Sewell, M.R.C.V.S., who started a canine infirmary six years ago at Larkhall Rise, Clapham, in a most convenient spot, opposite a station which is served by the following railways:—London, Chatham, and Dover, Brighton and South Coast, Great Northern, Midland, and London and North Western. From a comparatively small beginning the establishment has gradually grown until it has become the largest concern of the kind. It was a short time ago acquired by a Company, and is carried on under the title of Spratt's Sanatorium, Mr. Sewell still retaining the veterinary directorship.

Thinking that an illustrated description of the Sanatorium would be of interest to the readers of this journal, we commissioned our artist to make some sketches, and in pursuance of an invitation we accompanied Mr. Sewell on his usual afternoon tour of inspection, dressed in a working costume consisting of a canvas blouse and pantaloons to match. Across the large exercising ground we went to the first range of the kennels, where Mr. Sewell dressed the wound of a St. Bernard, on whom he had operated for cancer. In the adjoining kennel a pill had to be given to a Great Dane. It is astonishing how Mr. Sewell walks into the kennels of dogs he has never seen before, and it is a proof that as a rule it is only dread which induces dogs to bite: this fearlessness inspires his patients with confidence, and makes them tractable. We next visited a long row of kennels (No. 4 in the illustration) which has lately been erected with all the latest improvements. The ventilation is here, as in all the other buildings, efficaciously produced by windows at the top, so that the animals are never

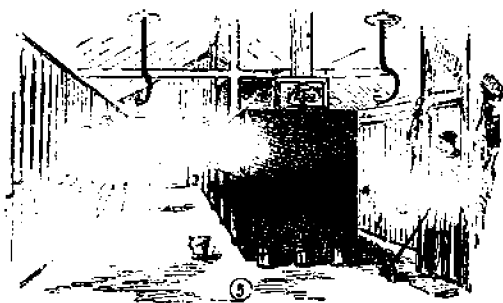

INTERIOR OF CENTRAL BUILDING.

exposed to any draught. In this row of kennels are large dogs, some of them famous champions, standing at stud because their owners home arrangements do not permit the reception of the sultan's elect. Then there are animals being conditioned for show. At the period of our visit it was "washing day" in preparation for the St. Bernard Club Show. Eighteen specimens of this breed had been thoroughly groomed in the morning, and were now stretching their limbs on benches covered with abundance of straw. In front of this wing is another playground, and through a door leading out of it we enter the central building (No. 3), the interior of which is represented in the sketch No. 5. Along two sides are kennels for medium sized dogs, and in the centre there are double tiers of cages for the smaller kinds. Our entry calls forth a lively barking chorus, but the stentorian voice of a kennelman quiets all the inmates with the exception of a Bulldog, who with a beery voice continues to growl from behind the rails, "I can't get at him." In the top row we notice some good Dandies, with those large quaint grey shaggy heads, looking like the produce of the misty clouds which sweep the heather on the moors of their native country,

One of these little fellows, looks intently out of his large eyes (with that appearance of depth of thought which one finds in no other breed) on a countryman of his, a Scottish Collie, who lies stretched out full length in a bottom compartment on the other side. This dog has the supercilious air of "Jeames"; he is now on board wages. His master, who paid a big price for him, is just now travelling. He misses nobody, and nobody misses him in the big house where his lot has been cast to do duty as an expensive ornament on the luxurious hearthrug in the drawing-room. Collies are more often than any other breed chosen for canine furniture of this kind.

Turning down the other side of the middle tier, we come upon several ladies' dogs, Yorkshires, Toy Spaniels, and Pugs, and here we quite expected to hear some whining, and see disconsolate looks, but the little creatures seemed happy enough. Perhaps the reason why they get reconciled to their new surroundings is a motherly-looking woman, who stands opposite the row, at the door of a neat little parlour. This matron is the representative of womanly care in the place. She has been endowed by nature with so extensive a nursing lap that even the fondest mistress of the most pampered pet would not hesitate to leave him under her protection.



INTERIOR OF DISTEMPER HOUSE.

There is also a dog with a history here. The story is prosaic, but quite befitting the member of a race which is associated with man in his "ups and downs." Here he sits at the entrance to one of the buildings with a look of indifference. He does not growl, nor does he wag his tail like a dog who has claims in the place like a house-dog would do. That dog had, sooth to say, seen better days; he had known the dissipation of shows and the pride of winning prizes and specials; he had been talked about and quarrelled about, and columns had been written about him in the papers. For some reason, however, he was sent here to take up his temporary residence. He ran into debt, and his master did not redeem him. In time he was allowed to go out when he liked, and he could have stopped away altogether, but, like the well-known prisoner in the Bastille, freedom had become irksome to him, and he never went away.

Although such illegal practices as cropping are naturally not carried on, fashion's foolishness has yet a department in this establishment. In a small room we find a canine hairdresser hard at work, shearing a Poodle carefully to the pattern desired by the dog's master with a clipper that works as close as a razor, having the advantage that the appearance of white hairs which shaving causes is avoided.

We are also taken to the pantry and the boiling-house where the food is prepared. It consists of Spratt's biscuits, stale bread, meat, of which about 1 cwt. a day is used, tripe, sheep's head, and fish. Large quantities of milk are also consumed.

Mr. Sewell has by this time finished his surgical labours, and we go to the distemper house (No. 1). He always leaves it to the last, so as not to have to return from it to the other dogs. This part of the hospital is particularly interesting. The disease is treated on scientific principles, and the care bestowed upon the patients would do honour to any hospital for human beings. A separate staff of servants who never are allowed in the other infirmary is in attendance. On the door of each kennel is a printed form, on which the temperature of the patient, taken with the clinical thermometer, is noted for the inspection of the surgeon, and on which he also writes his directions of treatment. The temperature in this compartment (a most important thing in this disease) is always kept at the same height.

We have now completed the round of the establishment, and pass out again into the land which leads into the main road, leaving Mr. Sewell at his work dressing wounds, taking temperatures, administering medicines, etc. We came away with the conviction that the treatment which the inmates of the Sanatorium receive, and particularly the careful application of all that veterinary science can do to alleviate their ailments, repays a debt of gratitude which the "lord of creation" owes to the most sensitive amongst his animal friends the long neglected dog.

## Dogs Boarded during their Owner's Absence from Home.

**ATTENDED TO DURING ILLNESS.**

OR

**PREPARED FOR EXHIBITION.**

Poodles Clipped in the Best Style, Fee 10s 6d.

Owners when leaving home may now be free from anxiety as to the safety of their pets during their absence.

Provision has also been made for breeding dogs, for which many gentlemen have not the necessary accommodation. This will be found to be a great convenience, as every care and attention can be given both before and after the puppies are born. We have an entirely separate infirmary for distemper Cases.

Dogs received at MR. SEWELL'S RESIDENCE,  
**55, ELIZABETH STREET, EATON SQUARE,**  
LONDON, S.W.

OR AT THE WORKS OF

**SPRATT'S PATENT LIMITED,**  
Henry Street, Bermondsey, London, S.E.

"THE DOG SANATORIUM, LIMITED," HENRY STREET, BERMONDSEY, S.E.

Mr. Sewell is at home for Consultation daily from 3 to 5 p.m.



In Tablets, 6d., and 1 lb. Bars, 1/- each.

## LITTLE'S SOLUBLE PHENYLE.

*Disinfectant, Deodoriser, Antiseptic, and Insecticide.*

**ABSOLUTELY NON-POISONOUS; WILL NOT STAIN, BURN, OR CORRODE.**

USED BY THE PRINCIPAL VETERINARY SURGEONS.

- Destroys all Bad Smells, all Contagion and Infection.
- Cures Mange, Ringworm, Herpes, Eczema, and all Skin Diseases.
- Kills Fleas and Lice upon Dogs and all other Animals.
- Heals all Wounds, Sores, Ulcers, Bites, Stings, &c.
- Cures "Bots," Tapeworm, "Worm in the Throat" when taken internally.

### READ THE FOLLOWING TESTIMONIALS.

From the Rev. WILLIAM EARDLEY,  
CANTLEY VICARAGE, near DONCASTER.

"I cannot in justice any longer withhold from you my testimony respecting Little's Soluble Phenyle. I have known and used it for about two years past, and found it efficient in allaying irritation, and removing cutaneous affections in horses, and in destroying FLEAS IN DOGS, and in soothing and healing wounds in either horses, dogs, or sheep. Its non-poisonous nature makes it specially valuable for these purposes."

From RICHARD L. ANGUS, Esq.,  
Steward to SIR C. F. SMYTH, Bart.

ACTON BURNELL, SHREWSBURY.  
"The clergyman of this village, who has had thirty years' experience in breeding dogs, &c., says that of the many remedies he has tried for lice, and as a disinfectant, he never knew of one so efficient as your Phenyle. He says it acts very beneficially on the COATS OF DOGS, making them glossy."

From Mr. F. CAMPBELL,  
Battif to G. W. MORRICE, Esq.

CATTORPE, RUGBY.  
"I am this day sending two 3-gallon drums to have them refilled for disinfecting purposes. I used it first three years ago, and since then I never like to be without it. I use it for RINGWORM, and LICE in CATTLE, HORSES, PIGS, and DOGS, and have no hesitation in recommending it strongly."

From F. J. DALE,  
Sec. SHEFFIELD AND HALLAMSHIRE KENNEL CLUB,  
SHEFFIELD, April 20th, 1883.

"I am instructed to forward you a copy of the resolution passed at the committee meeting held on the 19th inst. It was resolved unanimously:—That the best thanks of the Sheffield and Hallamshire Kennel Club be given to Messrs. Morris, Little & Son, for the most satisfactory way in which they disinfected the Dog Show held in the Drill Hall, Sheffield, on the 24th of March last and following days."

From JOHN J. STOTT,  
Hon. Sec., FYLDE FOX TERRIER CLUB,  
Preston, May 29th, 1883.

"We were extremely pleased with the Disinfectant you supplied to our Show at Blackpool, and consider it most effectual, at the same time being so easily applied."

From TOM MORGAN,  
BADSWORTH KENNELS, Pontefract.  
"I have found your Disinfectant Fluid to answer very satisfactorily."

From JOHN GILL,  
DUNKIRK, DARNALL, Dr. SHEFFIELD, June 25th, 1883.  
"I have much pleasure in certifying to the efficacy of your SOLUBLE PHENYLE as a cure for RED MANGE in DOGS. My Spaniel was in a shocking state when I was induced by a friend to try your Disinfectant, and after three applications a complete cure was the result."

In 6d., 1/-, & 2/6 Bottles. Quart Tins, 2/6; ½-gallon, 4/-; 1 Gallon Drums and upwards, 7/6 per gallon.

PROPRIETORS AND MANUFACTURERS:

**MORRIS, LITTLE & SON, DONCASTER.**

1889

SOLD BY ALL CHEMISTS.



EVERY FRIDAY, PRICE 2d.

EVERYBODY WHO KEEPS  
**DOGS,**  
**POULTRY,**  
**PIGEONS,**  
 OR  
**RABBITS**

SHOULD READ

**"THE STOCK-KEEPER."**

IT CONTAINS

THE FULLEST AND BEST REPORT OF ALL SHOWS.

"The Stock-keeper" is the Best Guide for Breeders and Exhibitors of Dogs, Poultry, Pigeons, &c. To be had of all Newsagents and Booksellers.

Offices—139 & 140, FLEET STREET, E.C.

## REGULATIONS.

For the Terrier Show at St. Stephen's Hall,  
 Westminster, April 3, 4, & 5, 1889.

—:—

1. The Show will be held under the Revised Rules of the Kennel Club.
2. **Entries.**—All entries should be made on or before Monday, March 25th, upon Certificates to be issued for that purpose. The Prize Lists and Certificates of Entry can be obtained at 325, Holloway Road, London, N., on application.
3. **Entry Fees.**—The Entrance Fee for each Dog will be 10s.; but Exhibitors can enter two or more Dogs in the SAME CLASS by paying 5s. each for all entries after the first. The Entrance Fees should be forwarded, with Certificates of Entry by March 25th. The Entrance Fee for Dogs not for competition, and Selling Classes is 5s. each. The Entry Fee in Local Classes is 5s., when the same dog is entered in OPEN or Members' Classes, and 10s. where it is not so entered.
4. **Power to Refuse Entries.**—The Committee reserve to themselves the right to refuse any entries that they may think fit to exclude.
5. **Labels.**—Address Labels with instructions for sending Dogs to the Show, will be forwarded to Exhibitors in due course. Should they not arrive Dogs should be sent to the Show, and the Secretary advised.
6. **Arrival of Dogs.**—The Dogs must be at the place of exhibition at Nine o'clock on Wednesday morning, April 3rd, after which hour the Committee will not undertake to receive Dogs. The keepers will receive Dogs on Tuesday, April 2nd. Arrangements have been made with all Railway Companies to deliver the Dogs as they arrive to St. Stephen's Hall; all charges by rail to be defrayed by Exhibitors. The Dogs will be received at the entrance doors by the officials.
7. **Food.**—The Dogs will be fed on Spratt's Patent Dog Cakes, and attended to free of expense to the Exhibitor during the exhibition.
8. **Keepers' Passes.**—Special keepers' passes under special regulations will be provided for *bona fide* keepers only. Exhibitors are requested to apply for these passes when making entries.
9. **Sale of Dogs.**—Exhibitors may state in the Certificates the price at which they are prepared to sell their Dogs, and the Sale must take place if an offer be made to purchase at the price fixed. A commission of 10 per cent. will be charged upon all sales, which must be effected through the Sale Office of the Show. If not for sale, that should be stated. Exhibitors may reduce the price of their dogs upon giving notice to the Secretary, who will furnish them with a card upon which the reduced price will be marked, at a charge of 1s. No other notice will be allowed to be placed over the Dogs. The commission will be charged on the actual price obtained for the Dog, and should it be found that an Exhibitor has sold any of his dogs without the Secretary's knowledge, the Committee shall deduct the commission of 10 per cent., and the exhibitor shall forfeit half the Prize money should the Dog have won a Prize.  
 No sale will take place till one hour after each breed has been judged; and if there are two or more applications by that time for the same Dog, the Committee shall at their discretion either have such Dog or Dogs sold by Auction or by tender, and any surplus thereon shall be equally divided between the Exhibitor and the Committee.
10. **Power to exclude Dogs.**—The Committee shall be empowered to exclude any dog which is not in a fit state for exhibition, either from disease, vice, or any other cause.

## REGULATIONS (continued).

**11. Judging.**—The judging will take place on Wednesday, April 3rd, and the Exhibition will continue open on each day of the Show from 10 a.m. until 10 p.m., except Friday, when the Show will be closed at 8 p.m. punctually. Exhibitors or their agents can remove their Dogs on presentation of the proper authority as soon as the Show closes. Dogs that are not called for by 9 p.m. on Friday, April 5th, will be forwarded as early as possible.

**12. Power to withhold Prizes.**—The Judges will be empowered and instructed to withhold any Prize or Prizes if the Dogs exhibited do not possess sufficient merit.

**13. Judges' Decisions.**—The decisions of the Judges will in all cases be final, except where misrepresentation or breach of the Rules is discovered. Should the Judge be prevented from fulfilling his engagement, the Committee reserve to themselves the right of appointing other gentlemen to fulfill the duties.

**14. Removing Dogs without leave.**—Any person found untying or removing a Dog from its number during the hours the Exhibition is open, without the permission of the Secretary, will be expelled from the Show.

**15. Removing Dogs at Night.**—Exhibitors will be permitted to take home their Dogs every evening after the Show is closed on leaving a deposit of £1 each Dog, and producing a receipt for the Entrance Fee. This deposit will be forfeited if the Dog is not returned before 10 o'clock every morning the Show is open; and if the winner of a Prize is taken out and not punctually returned, the Prize will also be forfeited.

**16. Ownership.**—All the Dogs shown must be the property of the Exhibitor in whose name they are entered. Any wilful misrepresentation with regard to the ownership, age, name, pedigree, breeder, or description of a Dog or Dogs, will, on being proved to the satisfaction of the Committee, be followed by the exclusion from all future Exhibitions of the person making such false statement *see* Kennel Club Rules, 1, 2, and 3.

**17. Safety of Dogs.**—The Committee will be most anxious for the care and safety of the Dogs sent for exhibition, or any other property entrusted to them; but it must be distinctly understood by Exhibitors and all other persons that the Committee will not be responsible for the loss, detention of, or damage to any Dogs or other property, whether arising from accident or other cause whatever, or from any act or omission of themselves, their officers, agents, servants, or others.

**18. Admissions.**—Admission to the Dog Show to Non-Exhibitors:—Wednesday, 9 a.m. to 2 p.m., 2s. 6d.; 2 p.m. to 6 p.m., 1s.; 6 p.m. to 10 p.m., 6d. Thursday, 10 a.m. to 6 p.m., 1s.; 6 p.m. to 10 p.m., 6d. Friday, 10 a.m. to close, 1s. Tickets can be purchased at these prices prior to the Show.

**19. Exhibitors' Free Passes.**—Exhibitors will receive a free pass, not transferable, available on any day of the Exhibition. This pass will be forwarded with the labels for the Dogs; it will admit the Exhibitor to the Exhibition any time the Show is open to the Public (not to the Royal Aquarium). It is not transferable, but a ticket must be obtained for re-admission.

**20. Power to Cancel Classes.**—The Committee reserve to themselves the right to cancel any Class or Classes, should they think fit, and in such case the amount of Entry Fee in that Class will be returned.

**21. Correspondence.**—All correspondence, inquiries, Entry Fees, and Subscriptions will be received by

CHARLES CRUFT,

325, Holloway Road,

London, N.,

and during the Show only at St. Stephen's Hall, Westminster, S.W.

A Handsome Illustrated Prize Card will be sent to each Winner of a Prize.

Should you require a Catalogue send 14 Stamps to the Secretary.

## \* SPECIALS. \*

## FOX TERRIERS.

1. SILVER CUP, Value 5 Guineas, Presented by the President, SIR HUMPHREY DE TRAFFORD, BART., for the best Fox Terrier, Rough or Smooth, in any of the Novice Classes. (Open to all.)
2. SILVER CUP, Value 3 Guineas, Presented by the SOUTHDOWN FOX TERRIER CLUB, for the best Smooth Fox Terrier in any of the Novice or Puppy Classes, the Property of a Member of the S.F.T.C.
3. SILVER CUP, Value 3 Guineas, Presented by SPRATT'S PATENT, MANUFACTURERS of Dog Kennels, and all appliances for Dogs, Game, and Poultry, for the best Smooth or Wire Fox Terrier, in the Open Classes.
4. SILVER CUP, Value 3 Guineas, Presented by the SOUTHDOWN FOX TERRIER CLUB, for the best Wire-Haired Fox Terrier in any of the Novice or Puppy Classes, the Property of a Member of the S.F.T.C.

## IRISH TERRIERS.

5. SPECIAL PRIZE, Value 2 Guineas, Presented by MR. W. H. BULLER, for the best Puppy bred by Exhibitor.

## WELSH TERRIERS.

6. TWENTY GUINEA CHALLENGE CUP, offered by the WELSH TERRIER CLUB, (subject to their Rules and Regulations), for the best Dog.
7. TWENTY GUINEA CHALLENGE CUP, offered by the WELSH TERRIER CLUB (subject to their Rules and Regulations), for the best Bitch.
8. SILVER CUP, Value 2 Guineas, Presented by the W.T.C., for the best Dog in Open Classes.
9. SILVER MEDAL will be given by the W.T.C., to the Winner of the Challenge Cup, for best Dog.
10. SILVER MEDAL will be given by the W.T.C., to the Winner of the Challenge Cup, for best Bitch.
11. SILVER CUP, Value 3 Guineas, Presented by the Judge, MR. E. POWELL, for the best Team of not less than 3.

*The above Specials are confined to Members of W.T.C.*

12. SILVER CUP, Value 5 Guineas, Presented by MR. O'NEIL, for the best Welsh Terrier in Open Classes, Exhibitor to reside within 25 miles of Charing Cross.
13. SILVER CUP, Presented by MR. H. JOYCE for the best Welsh Terrier Puppy exceeding 10 months.
14. SILVER CUP, Value 3 Guineas, Presented by MR. WIENER, for the best Bitch in Open Classes.

## SCOTTISH TERRIERS.

15. CHALLENGE CUP, (Club), Value 15 Guineas, for the best Dog whelped since December 31st., 1886.
16. CHALLENGE CUP, (Club), Value 15 Guineas, for the best Bitch whelped since December 31st., 1886.
17. SILVER CUP, Value 3 Guineas, Presented by the SCOTTISH TERRIER CLUB, for the best Dog in Open Puppy and Novice Classes.  
*The above are confined to Members of the Scottish Terrier Club (England.)*
18. SILVER CUP, Value 2 Guineas, Presented by SPRATT'S PATENT, LIMITED, for the best Bitch in Open Puppy and Novice Classes.
19. SILVER CUP, Value 2 Guineas, Presented by a FANCLER, for the best Brace of Scottish Terriers.

**SKYE TERRIERS.**

21. **SPECIAL PRIZE**, Club Medal, Presented by the S.T.C. for the best Drop-eared in Open Classes.
22. **SPECIAL PRIZE**, Club Medal, Presented by the S.T.C. for the best Prick-eared in Open Classes.
23. **SPECIAL PRIZE**, Value 1 Guinea, Presented by MRS. FREEMAN, for the best in Novice Class.  
(The above Specials are confined to Members.)
24. **SPECIAL PRIZE**, (Tortoiseshell Japanese Card Tray) Presented by an OLD FANCIER, for the best in Puppy Class.
25. **SPECIAL PRIZE**, (a handsomely carved Japanese Paper Knife) Presented by an OLD FANCIER, for the best Drop-eared Skye with best carried ears. (In all Classes).
26. **SPECIAL PRIZE**, (a handsomely carved Japanese Paper Knife) Presented by an OLD FANCIER, for the best Prick-eared Skye with best carried ears. (In all Classes).
27. **SPECIAL PRIZE**, (a Bronze Dinner Gong and Beater,) Presented by a BREEDER, for the best Team of not less than three, the Property of a Member S.T.C.

**DANDIES.**

28. **CHALLENGE CUP**, Value 50 Guineas is offered by the D.D.T.C. with a Commemorative Medal to winner, for the best in all Classes. (See Club conditions).
29. **SPECIAL PRIZE**, 1 Guinea Presented by D.D.T.C. for the best in open Pepper dogs.
30. **SPECIAL PRIZE**, 1 Guinea Presented by D.D.T.C. for the best in open Pepper Bitches.
31. **SPECIAL PRIZE**, 1 Guinea Presented by D.D.T.C. for the best Mustard.
32. **SPECIAL PRIZE**, 1 Guinea Presented by D.D.T.C. for the best Puppy.
33. **SPECIAL PRIZE**, 1 Guinea Presented by the Chairman, DR. AMSDEN for the best in Novice Classes that has never taken a Prize at any show.
34. **SPECIAL PRIZE**, 1 Guinea Presented by the Judge, MR. WILSON for the best Mustard under twelve months, on the first day of the show.
35. **SPECIAL PRIZE**, 1 Guinea Presented by MR. WALKER for the Mustard of all Classes with best ears in shape and particularly color.  
(The above confined to Members D.D.T.C.)
36. **SPECIAL PRIZE**, 1 Guinea Presented by MR. W. H. DUNN to the Breeder of the best Puppy in the Show.
37. **SPECIAL PRIZE**, 2 Guineas Presented by MR. LEATHAM for the best Team (of not less than three) Puppies any color, the Property of same Exhibitor and entered in their respective Classes.
38. **SPECIAL PRIZE**, (a Bronze Dinner Gong) Presented by a BREEDER for the best Team of Dandie Puppies (any color).

**BEDLINGTONS.**

39. **ONE POUND**, Presented by the B.T.C. for the best Dog in Open and Novice Classes.
40. **ONE POUND**, Presented by the B.T.C. for the best Bitch in Open and Novice Classes.
- 41.

**OLD ENGLISH TERRIERS.**

The A. & O.E.T.C. offer the following Special Prizes to be competed for by Members only in accordance with their Club rules.

42. **25 GUINEA CHALLENGE CUP**, for the best old English Terrier.
43. **10 GUINEA CHALLENGE CUP**, for the best old English Terrier of the opposite sex to the winner of the 25 Guinea Challenge Cup.

**AIREDALES.**

The Airedale and Old English Terrier Club offer the following Special Prizes, confined to Members of the A. & O.E.T.C., in accordance with Club Rules.

46. **25-GUINEA CHALLENGE CUP** for the best Airedale Dog or Bitch.
47. **10-GUINEA CHALLENGE CUP** for the best Airedale of opposite sex to the winner of 25-Guinea Challenge Cup.
48. **GOLD MEDAL** for the best Airedale in the Novice Classes.
49. **SILVER MEDAL** for the best Airedale of the opposite sex to the winner of Gold Medal in the Novice Classes.
50. **SILVER MEDAL** for the best Airedale in the Puppy Class.
51. A **GOLD MEDAL** for the best Airedale in the Local Dog or Bitch Class that has not won a Club Gold Medal at this Show, W. Ward Higgs will not compete for this Medal.
52. A **SILVER MEDAL** for the best Airedale in the Local Dog or Bitch Class of the opposite sex to the winner of the above Gold Medal and who has not won a Club Gold or Silver Medal at this Show, W. Ward Higgs will not compete for this Medal.
53. **SPECIAL PRIZE**, 1 Guinea Presented by MR. PERCY ROBERTS for the best Airedale Dog in any of the Novice Classes.

**BULL TERRIERS.**

54. **SPECIAL PRIZE**, 1 Guinea Presented by the B.T.C., for the best over 30 lbs. in Open Classes, confined to Members B.T.C.
55. **SPECIAL PRIZE**, 1 Guinea Presented by the B.T.C., for the best under 30 lb., in open Classes, confined to Members B.T.C.
56. **SPECIAL PRIZE**, Value 1 Guinea Presented by MR. C. E. FIRMSTONE, for the best in Novice Class, to exceed 30 lbs. in weight.
57. **SILVER CUP**, Value 1 Guinea Presented by MR. C. ALEXANDER, for the best uncropped Bull Terrier at the Show. Open to all.
58. **SPECIAL PRIZE**, Value Half Guinea Presented by MR. C. ALEXANDER, for the second best uncropped Bull Terrier. Open to all. (This is given only if there are not less than 6 Entries.)

**WHITE ENGLISH TERRIERS.**

59. **SILVER CUP**, Value 1 Guinea Presented by C. ALEXANDER, Esq. for the best uncropped White English Terrier.
60. **SPECIAL PRIZE**, Half-Guinea Presented by C. ALEXANDER, Esq. for the Second best uncropped White English Terrier, (only given if not less than six entries).

**BLACK AND TAN TERRIERS.**

61. **THE VICTORIA PRIZE**, Presented by the B. & T.T.C., in accordance with the Club Rules.
62. **SILVER CUP**, Value 3 Guineas, Presented by MR. ELLIS, for the best Team of B. and T. Toys.
63. **SILVER CUP**, Value 3 Guineas, Presented by MRS. HAMP, for the best in any of the Novice Classes.

**YORKSHIRE TERRIERS.**

64. **SPECIAL PRIZE**, a very Handsome Indian Vase, heavily engraved, Presented by a LADY, for the best Yorkshire Terrier, in the Open Local Class.

# Grant's Morella Cherry Brandy

*As supplied to Her Majesty at all the Royal Palaces.*

And to the Aristocracy and Gentry of the United Kingdom. The delicious product of the famed Kent Morellas. Supersedes Wine in many households. A most valuable Tonic.

# Grant's Morella Cherry Brandy

Much favoured by Sportsmen and Travellers.

Refreshing with Aerated Waters, and mixed with hot water it is a nice accompaniment to a cigar.

Can be obtained of all Wine Merchants, and at all Bars and Restaurants.

**BEWARE OF SPURIOUS IMITATIONS.**

MANUFACTURERS :-

**T. GRANT & SONS,**  
DISTILLERY, MAIDSTONE.

## WORMS IN DOGS.

**SYMPTOMS.**—Unhealthy appearance of coat, hair looking dead and not lying smoothly, condition bad although appetite good, spirits dull, nose hot and dry, and breath offensive.

"STONEHENGE," in his celebrated Work on the Dog, says:—"Worms are a fertile source of disease in the dog, destroying every year more puppies than distemper itself."

While "THE FIELD" says, concerning Distemper:—"All treatment, to be successful, must be preface by the expulsion of worms."

## Naldire's

# WORM POWDERS FOR DOGS

Safely remove these pests within one hour, at the same time giving tone to the stomach and producing first-rate condition in Dogs.

READ THE FOLLOWING TESTIMONIALS:

THE COTTAGE, SANDHILLS, WARSALL, *March 3rd, 1887.*

"Please send me one of NALDIRE'S WORM POWDERS. I consider them splendid. I had a Fox Terrier almost dead last Sunday, and got one of your Powders from a friend, and in fifteen minutes after the dog had had it, he passed a tape worm almost 60 feet in length."—E. J. BRAWS

WEST KENSINGTON, *June 20th, 1888.*

"A small Yorkshire Terrier of mine suffered so much from tape worms, that I determined, notwithstanding his being under 5 lbs., to try the effect of NALDIRE'S POWDERS on him. Having fasted the dog, I gave him a tenth part of one powder in half a teacupful of milk. He took it freely, and in less than ten minutes passed a worm several yards long, without showing any signs of distress whatever. The dog has been healthy ever since, and from a snappish cross-tempered animal, has become playful and affectionate."—J. G. PATEY.

Naldire's Worm Powders are **SOLD BY ALL CHEMISTS.**

In PACKETS, 1/-, 2/-, 3/6, and 5/- each, with FULL DIRECTIONS FOR USE.

## PRIZE LIST.

# FIFTH TERRIER SHOW

APRIL 3, 4, and 5, 1889,

WHEN THE FOLLOWING PRIZES WILL BE AWARDED.

*For list of Shows registered in or for the Kennel Club Stud Book, see end of Schedule*

**ENTRIES SHOULD BE MADE BY MARCH 25th, 1889.**

DEFINITION OF CLASSES AS REFERRED TO ON THE FOLLOWING PAGES:—

### Challenge Classes.

For all Dogs and Bitches that had qualified previously to 1st January, 1889, for competition in a Champion Class or Challenge Class, and for Winners of Ten Points in Open Classes at Shows registered in or for the Kennel Club Stud Books.

### Open Classes.

No Dog or Bitch will be qualified to compete in these Classes that has ever won Ten Points in Open Classes at Shows registered in or for the Kennel Club Stud Books, or that had qualified previously to 1st January, 1889, for competition in a Champion Class or Challenge Class, where Challenge Classes are provided for that breed.

N.B.—In estimating the number of points a dog has won, a First Prize gained at any Show under Kennel Club Rules previous to the 1st January, 1889, by any dog not fully qualified to compete in a Challenge Class under the Old Rules, will score Two Points.

### Puppy Classes.

Single Entries, not litters, over Three Months old and not exceeding One Year old on April 3rd, 1889, and not eligible for a Challenge Class.

### Novice Classes.

For all Dogs and Bitches that have never won a prize at a Show under Kennel Club Rules, Puppy Classes excepted.

### Team Classes.

For three or more Dogs or Bitches belonging to the same owner.

### Brace Classes.

For two Dogs or Bitches belonging to the same owner.

### Stud Dog or Brood Bitch.

To be judged by their Progeny of not less than two, unless where otherwise specified, which must be entered in their respective classes.

N.B.—All Dogs competing in Team or Brace Classes must be entered also in their respective classes, otherwise they are not eligible to compete.

### SMOOTH FOX TERRIERS.

FOR SPECIALS SEE PAGE 5.

### CHALLENGE CLASS.

### Class 1—DOGS & BITCHES.

Prize ... .. £2 0 0

### OPEN CLASSES.

### Class 3—DOGS.

First Prize ... .. £3 0 0

Second Prize ... .. 2 0 0

Third Prize ... .. 1 0 0

Fourth Prize ... .. Diploma

### Class 4—BITCHES.

First Prize ... .. £3 0 0

Second Prize .. ... 2 0 0

Third Prize ... .. 1 0 0

Fourth Prize ... .. Diploma

### NOVICE CLASSES.

For Dogs that have never won a Prize under Kennel Club Rules on or before March 25th, 1889.

### Class 5—DOGS.

First Prize ... .. £2 0 0

Second Prize ... .. 1 0 0

Third Prize ... .. 0 10 0

**Class 6—BITCHES.**

First Prize	...	£2	0	0
Second Prize	...	1	0	0
Third	...	0	10	0

**Class 7—DOGS & BITCHES.**

For Dogs that have never won a First Prize under Kennel Club Rules on or before 25th March, 1889.

First Prize	...	£2	0	0
Second Prize	...	1	0	0
Third Prize	...	0	10	0
Fourth Prize	...			Diploma

**Class 8—DOGS & BITCHES.**

For Dogs that have never won a Prize of any description, Puppy or otherwise, on or before 3rd April, 1889.

First Prize	...	£2	0	0
Second Prize	...	1	0	0
Third Prize	...	0	10	0
Fourth Prize	...			Diploma

**PUPPY CLASSES.****Class 9—DOGS (Single Entries, not Litters).**

Over 3 months and not exceeding 1 year, on 3rd April, 1889.

First Prize	...	£2	0	0
Second Prize	...	1	0	0
Third Prize	...	0	10	0
Fourth Prize	...			Diploma

**Class 10—BITCHES (Single Entries, not Litters).**

Over 3 months and not exceeding 1 year, on 3rd April 1889.

First Prize	...	£2	0	0
Second Prize	...	1	0	0
Third Prize	...	0	10	0
Fourth Prize	...			Diploma

**BRACE CLASS.****Class 11.**

For the best Brace of Smooth Fox Terrier Puppies, each to be entered in their respective Classes.

First Prize	...	£2	0	0
Second Prize	...	0	10	0
Third Prize	...			Diploma

SEE MEMBERS' CLASSES.

SEE LOCAL CLASSES.

**WIRE-HAIRED****FOX TERRIERS.**

FOX SPECIALS SEE PAGE 5.

**CHALLENGE CLASS.****Class 12—DOGS & BITCHES.**

Prize	...	£2	0	0
-------	-----	----	---	---

**OPEN CLASSES.****Class 13—DOGS.**

First Prize	...	£3	0	0
Second Prize	...	2	0	0
Third Prize	...	1	0	0

**Class 14—BITCHES.**

First Prize	...	£3	0	0
Second Prize	...	2	0	0
Third Prize	...	1	0	0

**NOVICE CLASSES.**

For Dogs that have never won a Prize under Kennel Club Rules on or before March 25th, 1889.

**Class 15—DOGS.**

First Prize	...	£2	0	0
Second Prize	...	1	0	0
Third Prize	...	0	10	0

**Class 16—BITCHES.**

First Prize	...	£2	0	0
Second Prize	...	1	0	0
Third Prize	...	0	10	0

**Class 17—DOGS & BITCHES.**

For Dogs that have never won a First Prize under Kennel Club Rules, on or before March 25th, 1889.

First Prize	...	£2	0	0
Second Prize	...	1	0	0
Third Prize	...	0	10	0

**Class 18—DOGS & BITCHES.**

For Dogs that have never won a Prize of any description, Puppy or otherwise.

First Prize	...	£2	0	0
Second Prize	...	1	0	0
Third Prize	...	0	10	0

**PUPPY CLASSES.****Class 19—DOGS (Single Entries, not Litters).**

Over 3 months and not exceeding 1 year, on April 3rd, 1889.

First Prize	...	£2	0	0
Second Prize	...	1	0	0
Third Prize	...			Diploma

**Class 20—BITCHES.**

First Prize	...	£2	0	0
Second Prize	...	1	0	0
Third Prize	...			Diploma

**BRACE CLASS.****Class 21.**

For the best Brace of Wire-Haired Fox Terrier Puppies, each to be shown in their respective classes.

First Prize	...	£2	0	0
Second Prize	...	0	10	0

**MEMBERS' CLASSES.**

These Classes are confined to Members of the undermentioned Clubs:—

FOX TERRIER CLUB.  
SHEFFIELD F.T.C.  
MIDLAND F.T.C.  
SOUTHDOWN F.T.C.  
SHREWSBURY F.T.C.  
DARLINGTON F.T.C.  
ISLE OF WIGHT FOX TERRIER CLUB.  
LONDON F.T.C.

(For Smooth Fox Terriers).

**CHALLENGE CLASSES.****Class 22—DOGS.**

Prize	...	Society's Medal
-------	-----	-----------------

**Class 23—BITCHES.**

Prize	...	Society's Medal
-------	-----	-----------------

**OPEN CLASSES.****Class 24—DOGS.**

First Prize	...	£3	0	0
Second Prize	...	2	0	0
Third Prize	...	1	0	0
Fourth Prize	...			Diploma

**Class 25—BITCHES.**

First Prize	...	£3	0	0
Second Prize	...	2	0	0
Third Prize	...	1	0	0
Fourth Prize	...			Diploma

**NOVICE CLASSES.**

For Dogs that have never won a Prize under K.C. Rules on or before March 25th, 1889.

**Class 26—DOGS & BITCHES.**

First Prize	...	£2	0	0
Second Prize	...	1	0	0
Third Prize	...	0	10	0
Fourth Prize	...			Diploma

**Class 27—DOGS or BITCHES.**

For Dogs that have never won a Prize of any description, Puppy or otherwise, on or before April 3rd, 1889.

First Prize	...	£2	0	0
Second Prize	...	1	0	0
Third Prize	...	0	10	0
Fourth Prize	...			Diploma

**PUPPY CLASSES.**

(Single entries, not litters, over 3 and under 12 months).

**Class 28—DOGS & BITCHES.**

First Prize	...	£2	0	0
Second Prize	...	1	0	0
Third Prize	...	0	10	0
Fourth Prize	...			Diploma

**BRACE CLASS.**

(For either or both sex).

**Class 29.**

First Prize	...	£2	0	0
Second Prize	...	0	10	0
Third Prize	...			Diploma

(For Wire-Haired Fox Terriers).

**CHALLENGE CLASSES.****Class 30—DOGS.**

Prize	...	Society's Medal
-------	-----	-----------------

**Class 31—BITCHES.**

Prize	...	Society's Medal
-------	-----	-----------------

**OPEN CLASSES.****Class 32—DOGS.**

First Prize	...	£3	0	0
Second Prize	...	2	0	0
Third Prize	...	1	0	0
Fourth Prize	...			Diploma

**Class 33—BITCHES.**

First Prize	...	£3	0	0
Second Prize	...	2	0	0
Third Prize	...	1	0	0
Fourth Prize	...			Diploma

**NOVICE CLASSES.**

For Dogs that have never won a Prize under K.C. Rules on or before March 25th, 1889.

**Class 34—DOGS & BITCHES.**

First Prize	...	£2	0	0
Second Prize	...	1	0	0
Third Prize	...	0	10	0
Fourth Prize	...			Diploma

**Class 35—DOGS or BITCHES.**

For Dogs that have never won a Prize of any description, Puppy or otherwise, on or before April 3rd, 1889.

First Prize	...	£2 0 0
Second Prize	...	1 0 0
Third Prize	...	0 10 0
Fourth Prize	...	Diploma

**PUPPY CLASSES.****Class 36—DOGS & BITCHES.**

First Prize	...	£2 0 0
Second Prize	...	0 10 0
Third Prize	...	0 10 0
Fourth Prize	...	Diploma

**Class 37.—BRACE CLASS.**

For either or both sex.

First Prize	...	£2 0 0
Second Prize	...	1 0 0
Third Prize	...	Diploma

**SMOOTH FOX TERRIERS.****LOCAL CLASSES.**

Open to all residing within a distance of 25 miles from Charing Cross.

**CHALLENGE CLASS.**

<b>Class 38—DOGS or BITCHES.</b>	Prize	...	Society's Medal.
----------------------------------	-------	-----	------------------

**OPEN CLASSES.****Class 39—DOGS or BITCHES.**

First Prize	...	£2 0 0
Second Prize	...	1 0 0
Third Prize	...	0 10 0
Fourth Prize	...	Diploma

**NOVICE CLASSES.**

For Dogs that have never won a Prize under K.C. Rules on or before March 25th, 1889.

**Class 40—DOGS & BITCHES.**

First Prize	...	£2 0 0
Second Prize	...	1 0 0
Third Prize	...	0 10 0
Fourth Prize	...	Diploma

**Class 41—DOGS & BITCHES.**

For Dogs that have never won a Prize of any description, Puppy or otherwise, on or before April 3rd, 1889.

First Prize	...	£2 0 0
Second Prize	...	1 0 0
Third Prize	...	0 10 0
Fourth Prize	...	Diploma

**PUPPY CLASS.**

Single entries not litters.

**Class 42—DOGS & BITCHES\***

First Prize	...	£2 0 0
Second Prize	...	1 0 0
Third Prize	...	0 10 0
Fourth Prize	...	Diploma

**BRACE CLASS.****Class 43.**

First Prize	...	£2 0 0
Second Prize	...	0 10 0

**WIRE-HAIRED FOX TERRIERS****LOCAL CLASSES.**

Open to all residing within a distance of 25 miles of Charing Cross.

**CHALLENGE CLASS.**

<b>Class 44—DOGS or BITCHES.</b>	Prize	...	Society's Medal
----------------------------------	-------	-----	-----------------

**OPEN CLASSES.****Class 45—DOGS & BITCHES.**

First Prize	...	£2 0 0
Second Prize	...	1 0 0
Third Prize	...	0 10 0
Fourth Prize	...	Diploma

**NOVICE CLASSES.**

For Dogs that have never won a Prize under K.C. Rules on or before March 25th, 1889.

**Class 46—DOGS & BITCHES.**

First Prize	...	£2 0 0
Second Prize	...	1 0 0
Third Prize	...	0 10 0
Fourth Prize	...	Diploma

**Class 47—DOGS & BITCHES.**

For Dogs that have never won a Prize of any description, Puppy or otherwise on or before April 3rd, 1889.

First Prize	...	£2 0 0
Second Prize	...	1 0 0
Third Prize	...	0 10 0
Fourth Prize	...	Diploma

**PUPPY CLASS.****Class 48—DOGS & BITCHES.**

First Prize	...	£2 0 0
Second Prize	...	1 0 0
Third Prize	...	0 10 0
Fourth Prize	...	Diploma

**BRACE CLASS.****Class 49.**

First Prize	...	£2 0 0
Second Prize	...	0 10 0

**IRISH TERRIERS.**

FOR SPECIALS SEE PAGE 5.

**CHALLENGE CLASS.****Class 50—DOGS & BITCHES.**

First Prize	...	Society's Medal
Second Prize	...	Silver Medal

**OPEN CLASSES.****Class 51—DOGS.**

First Prize	...	£2 0 0
Second Prize	...	1 0 0
Third Prize	...	0 10 0
Fourth Prize	...	Diploma

**Class 52—BITCHES.**

First Prize	...	£2 0 0
Second Prize	...	1 0 0
Third Prize	...	0 10 0
Fourth Prize	...	Diploma

**NOVICE CLASSES.**

For Dogs that have never won a prize under Kennel Club Rules on or before March 25th, 1889.

**Class 53—DOGS.**

First Prize	...	£2 0 0
Second Prize	...	1 0 0
Third Prize	...	Diploma

**Class 54—BITCHES.**

First Prize	...	£2 0 0
Second Prize	...	1 0 0
Third Prize	...	Diploma

**Class 55—DOGS & BITCHES.**

For Dogs that have never won a prize of any description, Puppy or otherwise.

First Prize	...	£2 0 0
Second Prize	...	1 0 0
Third Prize	...	Diploma

**PUPPY CLASS.**

(Single entries, not litters).

**Class 56—DOGS & BITCHES.**

First Prize	...	£2 0 0
Second Prize	...	1 0 0
Third Prize	...	Diploma

**BRACE CLASS.****Class 57.**

First Prize	...	£1 0 0
Second Prize	...	0 10 0
Third Prize	...	Diploma

**WELSH TERRIERS.**

FOR SPECIALS SEE PAGE 5.

**CHALLENGE CLASS.****Class 58—DOGS or BITCHES.**

Prize	...	£1 0 0
-------	-----	--------

**OPEN CLASSES.****Class 59—DOGS.**

First Prize	...	£2 0 0
Second Prize	...	1 0 0
Third Prize	...	0 10 0
Fourth Prize	...	Diploma

**Class 60—BITCHES.**

First Prize	...	£2 0 0
Second Prize	...	1 0 0
Third Prize	...	0 10 0
Fourth Prize	...	Diploma

**NOVICE CLASS.****Class 61—DOGS & BITCHES.**

First Prize	...	£2 0 0
Second Prize	...	1 0 0
Third Prize	...	10 0
Fourth Prize	...	Diploma

**PUPPY CLASSES.****Class 62—DOGS.**

First Prize	...	£2 0 0
Second Prize	...	1 0 0
Third Prize	...	10 0
Fourth Prize	...	0 7 6

**CLASS 63—BITCHES.**

First Prize	...	£2 0 0
Second Prize	...	1 0 0
Third Prize	...	0 10 0
Fourth Prize	...	0 7 6

**BRACE CLASS.****Class 64.**

First Prize	...	Silver Medal
Second Prize	...	Diploma

## SCOTTISH TERRIERS.

(Hard Haired).

FOR SPECIALS SEE PAGE 5.

## CHAMPION CLASS.

**Class 65—DOGS & BITCHES.**  
Prize ... Society's Medal.

## CHALLENGE CLASSES.

## Class 66—DOGS.

First Prize ... £2 0 0  
Second Prize ... 1 0 0

## Class 67—BITCHES.

First Prize ... £2 0 0  
Second Prize ... 1 0 0

## OPEN CLASSES.

## Class 68—DOGS.

First Prize ... £2 0 0  
Second Prize ... 1 0 0  
Third Prize ... 0 10 0

## Class 69—BITCHES.

First Prize ... £2 0 0  
Second Prize ... 1 0 0  
Third Prize ... 0 10 0

## NOVICE CLASS.

## Class 70—DOGS &amp; BITCHES.

First Prize ... £2 0 0  
Second Prize ... 1 0 0  
Third Prize ... 0 10 0  
Fourth Prize ... Diploma

## PUPPY CLASSES.

## Class 71—DOGS.

First Prize ... £2 0 0  
Second Prize ... 1 0 0  
Third Prize ... 0 10 0

## Class 72—BITCHES.

First Prize ... £2 0 0  
Second Prize ... 1 0 0  
Third Prize ... Diploma

## BRACE CLASS.

## Class 73.

First Prize ... Special No.  
Second Prize ... £1 0 0  
Third Prize ... 0 10 0  
Fourth Prize ... Diploma

## SKYE TERRIERS.

FOR SPECIALS SEE PAGE 6—

## CHALLENGE CLASS.

(Prick or drop-eared).

## Class 74—DOGS &amp; BITCHES

Prize ... Society's Medal.

## OPEN CLASSES.

Prick-eared.

## Class 75—DOGS.

First Prize ... £2 0 0  
Second Prize ... 1 0 0  
Third Prize ... Diploma

## Class 76—BITCHES.

First Prize ... £2 0 0  
Second Prize ... 1 0 0  
Third Prize ... Diploma

## Class 77—DOGS &amp; BITCHES.

Drop-eared.

First Prize ... £2 0 0  
Second Prize ... 1 0 0  
Third Prize ... 0 10 0  
Fourth Prize ... Diploma

## PUPPY CLASS.

Single entries.

## Class 78—DOGS or BITCHES.

First Prize ... Silver Medal  
Second Prize ... Bronze Medal  
Third Prize ... Diploma

## NOVICE CLASS.

## Class 79—DOGS &amp; BITCHES.

First Prize ... Silver Medal  
Second Prize ... Bronze Medal  
Third Prize ... Diploma

## BRACE CLASSES.

## Class 80—Drop-eared.

Prize ... Silver Medal

## Class 81—Prick-eared.

Prize ... Silver Medal

## TEAM CLASS.

## Class 82.

Prize ... Silver Medal

## LOCAL CLASSES.

## CHALLENGE CLASS.

Drop or Prick-eared.

## Class 83—DOGS or BITCHES.

Prize ... Silver Medal

## OPEN CLASS.

## Class 84—DOGS or BITCHES.

First Prize ... £2 0 0  
Second Prize ... 1 0 0  
Third Prize ... 0 10 0  
Fourth Prize ... Diploma

## BRACE CLASS.

## Class 85.

Prize ... Silver Medal

## CLYDESDALE TERRIERS.

## Class 86—DOGS &amp; BITCHES.

First Prize ... £2 0 0  
Second Prize ... 1 0 0  
Third Prize ... Diploma

## DANDIE DINMONTS.

FOR SPECIALS SEE PAGE 6.

## CHALLENGE CLASSES.

## Class 87—DOGS.

First Prize ... Society's Medal  
Second Prize ... Diploma

## Class 88—BITCHES.

First Prize ... Society's Medal  
Second Prize ... Diploma

## OPEN CLASSES.

## Class 89—MUSTARD DOGS.

First Prize ... £2 0 0  
Second Prize ... 1 0 0  
Third Prize ... Diploma

## Class 90.

## MUSTARD BITCHES.

First Prize ... £2 0 0  
Second Prize ... 1 0 0  
Third Prize ... Diploma

## Class 91—PEPPER DOGS.

First Prize ... £2 0 0  
Second Prize ... 1 0 0  
Third Prize ... 0 10 0  
Fourth Prize ... Diploma

## Class 92—PEPPER BITCHES.

First Prize ... £2 0 0  
Second Prize ... 1 0 0  
Third Prize ... 0 10 0  
Fourth Prize ... Diploma

## PUPPY CLASSES.

(Single Entries, not Litters).

## Class 93—DOGS.

First Prize ... £2 0 0  
Second Prize ... 1 0 0  
Third Prize ... Diploma

## Class 94—BITCHES.

First Prize ... £2 0 0  
Second Prize ... 1 0 0  
Third Prize ... Diploma

## NOVICE CLASS.

## Class 95—DOGS &amp; BITCHES.

First Prize ... £2 0 0  
Second Prize ... 1 0 0  
Third Prize ... 0 10 0

## TEAM CLASSES.

## Class 96—PEPPERS.

First Prize ... Silver Medal  
Second Prize ... Diploma

## Class 97—MUSTARDS.

First Prize ... Silver Medal  
Second Prize ... Diploma

## Class 98—PUPPIES.

First Prize ... Silver Medal  
Second Prize ... Diploma

## BRACE CLASSES.

## Class 99—PEPPER (Dogs only).

First Prize ... Silver Medal  
Second Prize ... Diploma

## Class 100—PEPPER (Bitches only).

First Prize ... Silver Medal  
Second Prize ... Diploma

## Class 101—MUSTARDS (Dogs or Bitches).

First Prize ... Silver Medal  
Second Prize ... Diploma

## Class 102—PUPPIES (Any Variety or Sex).

First Prize ... Silver Medal  
Second Prize ... Diploma

## LOCAL CLASSES.

(Any Variety of Dandies).

Confined to Exhibitors residing within  
25 miles of Charing Cross.

## CHALLENGE CLASS.

**Class 103—DOGS or BITCHES.**  
Prize ... Silver Medal

OPEN CLASS.

Class 104—DOGS or BITCHES.

First Prize	...	...	£2	0	0
Second Prize	...	...	1	0	0
Third Prize	...	...	0	10	0
Fourth Prize	...	...	Diploma		

NOVICE CLASS.

For Dogs that have never won a Prize of any description.

Class 105—DOGS or BITCHES.

First Prize	...	...	£2	0	0
Second Prize	...	...	1	0	0
Third Prize	...	...	0	10	0
Fourth Prize	...	...	Diploma		

BRACE CLASS.

Class 106.

First Prize	...	Silver Medal
Second Prize	...	Diploma

BEDLINGTONS.

FOR SPECIALS SEE PAGE 6.

CHALLENGE CLASS.

Class 107—DOGS & BITCHES.

Prize	...	Diploma
-------	-----	---------

OPEN CLASSES.

Class 108—DOGS.

First Prize	...	...	£2	0	0
Second Prize	...	...	1	0	0
Third Prize	...	...	Diploma		

Class 109—BITCHES.

First Prize	...	...	£2	0	0
Second Prize	...	...	1	0	0
Third Prize	...	...	Diploma		

NOVICE CLASS.

Class 110—DOGS & BITCHES.

First Prize	...	...	£2	0	0
Second Prize	...	...	0	10	0
Third Prize	...	...	Diploma		

BRACE CLASS.

Class 111.

First Prize	...	Silver Medal
Second Prize	...	Bronze Medal

AIREDALE TERRIERS.

FOR SPECIALS SEE PAGE 7.

CHALLENGE CLASS.

Class 112—DOGS or BITCHES.

First Prize	...	Silver Medal
Second Prize	...	Bronze Medal

OPEN CLASSES.

Class 113—DOGS.

First Prize	...	...	£2	0	0
Second Prize	...	...	1	0	0
Third Prize	...	...	0	10	0

Class 114—BITCHES.

First Prize	...	...	£2	0	0
Second Prize	...	...	1	0	0
Third Prize	...	...	0	10	0

NOVICE CLASSES.

Class 115—DOGS.

First Prize	...	...	£2	0	0
Second Prize	...	...	1	0	0
Third Prize	...	...	0	10	0

Class 116—BITCHES.

First Prize	...	...	£2	0	0
Second Prize	...	...	1	0	0
Third Prize	...	...	0	10	0

PUPPY CLASS.

Class 117—DOGS or BITCHES.

First Prize	...	...	£2	0	0
Second Prize	...	...	1	0	0
Third Prize	...	...	0	10	0

BRACE CLASS.

Class 118.

First Prize	...	Silver Medal
Second Prize	...	Bronze Medal
Third Prize	...	Diploma

TEAM CLASS.

Class 119.

First Prize	...	Silver Medal
Second Prize	...	Bronze Medal
Third Prize	...	Diploma

LOCAL CLASSES.

For Exhibitors residing within 25 miles of Charing Cross.

CHALLENGE CLASS.

Class 120.

Prize	...	Diploma
-------	-----	---------

OPEN CLASS.

Class 121—DOGS or BITCHES.

First Prize	...	...	£2	0	0
Second Prize	...	...	1	0	0
Third Prize	...	...	0	10	0
Fourth Prize	...	...	Diploma		

NOVICE CLASS.

WIRE-HAIRED OR STRAIGHT HARD-COATED.  
(Under 20lbs. in weight).

Class 127—DOGS & BITCHES.

First Prize	...	...	£2	0	0
Second Prize	...	...	1	0	0
Third Prize	...	...	0	10	0

*Crowley*  
*Gillard*  
*Rowe*  
*Tolley*

Third Prize ... 0 10 0

WIRE-HAIRED OR STRAIGHT HARD-COATED.  
(Over 20lbs in weight).

Class 126—DOGS & BITCHES.

First Prize	...	...	£2	0	0
Second Prize	...	...	1	0	0
Third Prize	...	...	0	10	0

Prize ... Society's Medal.

LOCAL CLASS.

Any Weight.

Class 135—DOG OR BITCH.

First Prize	...	...	£2	0	0
Second Prize	...	...	0	10	0
Third Prize	...	...	Diploma		

# SPRATT'S PATENT MEAT "FIBRINE" VEGETABLE Dog Cakes. (WITH BEETROOT.)

Mr. JOHN WORTHINGTON, Fishguard, writes—  
"Feb. 1, 1888.

"I have fed my hounds and pointers and setters and other dogs on your Cakes for years, and highly approve of them, as I have had no mange in the kennel since I began to use them.

"P.S.—Mine are Otter Hounds, but I hunt foxes often in the winter."

TO AVOID IMPOSITION  
PLEASE NOTE STAMP.

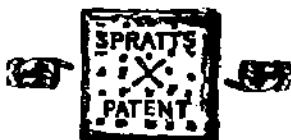

## BOULTON AND PAUL, NORWICH.

Inventors and Manufacturers.

### PORTABLE DOG KENNELS.

Registered No. 30550.

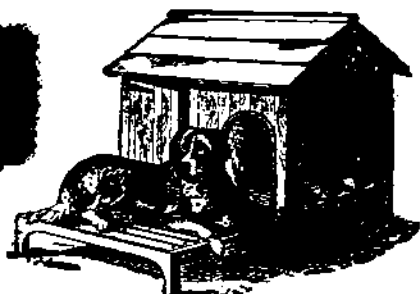

REGISTERED.

These Kennels are well made and highly finished. All parts are accessible for Cleansing and Disinfecting. The Sliding Bench is an important addition to the Kennel, as it adds greatly to the comfort of the dog. They take to pieces and pack flat for travelling.

Reduced Cash Prices. Carriage Paid on Orders of £2 value.

For Terriers £1; For Collies, Spaniels, or Retrievers, £1 15s.; for St. Bernard's or Mastiffs, £2 15s.; Registered Sliding Bench 3s. extra; Trough, 3s. extra.

EVERY REQUISITE for the Kennel, Poultry Yard, Pheasantry, Aviary, &c., manufactured by ourselves. Catalogues free by Post.

## Registered "SANITAS" THE BEST DISINFECTANT.

FRAGRANT! NON-POISONOUS! DOES NOT STAIN!

The KENNEL CLUB SHOW, 1887, was Disinfected with SANITAS.

ALL DOG OWNERS SHOULD USE

SANITAS FLUID for washing Wounds and Sores on Dogs.  
SANITAS CRUDE FLUID } For Disinfecting Kennels, Stables, Drains, Manure Heaps, &c.  
SANITAS POWDER }  
SANITAS SAW DUST for mixing with the Bedding, Litter, &c.  
SANITAS ANIMAL SOAP for washing Dogs and other Animals, and cure of Skin Disease.  
SANITAS VETERINARY OINTMENT, an after-dressing, for Wounds.

"Cleanliness, fresh air, and a sprinkling of SANITAS, either Fluid or in Powder, should render any Stable or Kennel disease-proof."—GORDON STABLES, Esq., O.M., M.D., B.N.

THE SANITAS CO., LTD.,  
THREE COLT LANE, BETHNAL GREEN, LONDON, E.

### HENRY'S GREAT INDIAN KENNEL REQUISITES.



## HIPPACEA PILLS

Purify the Blood without Purgings

The Remedy for Eczema, Ear Canker, Mange Sores, Wounds, &c., &  
ENDORSED BY THE PRESIDENT OF THE KENNEL CLUB, &c.

PRICES of "HIPPACEA." Post Free, 2/9, 5/3, and 10/3 Per Tin.  
" " " PILLS " " 1/-, 2/6, and 6/- Per Box.

HENRY'S GREAT INDIAN REMEDIES, LIMITED,  
43, KING WILLIAM ST., LONDON, E.C., and MADRAS, INDIA.  
F. H. BOWDEN,

Telegraphic Address—"HIPPACEA, LONDON."

Managing Director.

## OPEN CLASS.

## Class 104—DOGS or BITCHES.

First Prize	... ..	£2 0 0
Second Prize	... ..	1 0 0
Third Prize	... ..	0 10 0
Fourth Prize	... ..	Diploma

## NOVICE CLASS.

For Dogs that have never won a Prize of any description.

## Class 105—DOGS or BITCHES.

First Prize	... ..	£2 0 0
Second Prize	... ..	1 0 0
Third Prize	... ..	0 10 0
Fourth Prize	... ..	Diploma

## BRACE CLASS.

## Class 106.

First Prize	... ..	Silver Medal
Second Prize	... ..	Diploma

## BEDLINGTONS.

FOR SPECIALS SEE PAGE 6.

## CHALLENGE CLASS.

## Class 107—DOGS &amp; BITCHES.

Prize	... ..	Diploma
-------	--------	---------

## OPEN CLASSES.

## Class 108—DOGS.

First Prize	... ..	£2 0 0
Second Prize	... ..	1 0 0
Third Prize	... ..	Diploma

## Class 109—BITCHES.

First Prize	... ..	£2 0 0
Second Prize	... ..	1 0 0
Third Prize	... ..	Diploma

## NOVICE CLASS.

## Class 110—DOGS &amp; BITCHES.

First Prize	... ..	£2 0 0
Second Prize	... ..	0 10 0
Third Prize	... ..	Diploma

## BRACE CLASS.

## Class 111.

First Prize	... ..	Silver Medal
Second Prize	... ..	Bronze Medal

## AIREDALE TERRIERS,

FOR SPECIALS SEE PAGE 7.

## CHALLENGE CLASS.

## Class 112—DOGS or BITCHES.

First Prize	... ..	Silver Medal
Second Prize	... ..	Bronze Medal

## OPEN CLASSES.

## Class 113—DOGS.

First Prize	... ..	£2 0 0
Second Prize	... ..	1 0 0
Third Prize	... ..	0 10 0

## Class 114—BITCHES.

First Prize	... ..	£2 0 0
Second Prize	... ..	1 0 0
Third Prize	... ..	0 10 0

## NOVICE CLASSES.

## Class 115—DOGS.

First Prize	... ..	£2 0 0
Second Prize	... ..	1 0 0
Third Prize	... ..	0 10 0

## Class 116—BITCHES.

First Prize	... ..	£2 0 0
Second Prize	... ..	1 0 0
Third Prize	... ..	0 10 0

## PUPPY CLASS.

## Class 117—DOGS or BITCHES.

First Prize	... ..	£2 0 0
Second Prize	... ..	1 0 0
Third Prize	... ..	0 10 0

## BRACE CLASS.

## Class 118.

First Prize	... ..	Silver Medal
Second Prize	... ..	Bronze Medal
Third Prize	... ..	Diploma

## TEAM CLASS.

## Class 119.

First Prize	... ..	Silver Medal
Second Prize	... ..	Bronze Medal
Third Prize	... ..	Diploma

## LOCAL CLASSES.

For Exhibitors residing within 25 miles of Charing Cross.

## CHALLENGE CLASS.

## Class 120.

Prize	... ..	Diploma
-------	--------	---------

## OPEN CLASS.

## Class 121—DOGS or BITCHES.

First Prize	... ..	£2 0 0
Second Prize	... ..	1 0 0
Third Prize	... ..	0 10 0
Fourth Prize	... ..	Diploma

## NOVICE CLASS.

For Dogs never having won a Prize of any description.

## Class 122—DOGS or BITCHES.

First Prize	... ..	£2 0 0
Second Prize	... ..	1 0 0
Third Prize	... ..	0 10 0
Fourth Prize	... ..	Diploma

## BRACE CLASS.

## Class 123.

First Prize	... ..	Silver Medal
Second Prize	... ..	Bronze Medal
Third Prize	... ..	Diploma

## OLD ENGLISH TERRIERS.

FOR

## CHALLENGE CUPS

AND

## SPECIAL PRIZES

See Page 6.

All Exhibitors in Old English Classes must, previous to time of entry, be registered at the Kennel Club as Wire-haired Old English Terriers, in Registration Class 56 not in 53, as formerly.

## ROUGH OR BROKEN-COATED.

(Over 20lbs in weight).

## Class 124—DOGS &amp; BITCHES.

First Prize	... ..	£2 0 0
Second Prize	... ..	1 0 0
Third Prize	... ..	0 10 0

## ROUGH OR BROKEN-COATED.

(Under 20lbs in weight).

## Class 125—DOGS &amp; BITCHES.

First Prize	... ..	£2 0 0
Second Prize	... ..	1 0 0
Third Prize	... ..	0 10 0

## WIRE-HAIRED OR STRAIGHT

HARD-COATED.

(Over 20lbs in weight).

## Class 126—DOGS &amp; BITCHES.

First Prize	... ..	£2 0 0
Second Prize	... ..	1 0 0
Third Prize	... ..	0 10 0

## WIRE-HAIRED OR STRAIGHT

HARD-COATED.

(Under 20lbs. in weight).

## Class 127—DOGS &amp; BITCHES.

First Prize	... ..	£2 0 0
Second Prize	... ..	1 0 0
Third Prize	... ..	0 10 0

## BULL TERRIERS.

FOR SPECIALS SEE PAGE 7.

## CHALLENGE CLASS.

## Class 128—DOGS &amp; BITCHES.

Prize	... ..	Society's Medal
-------	--------	-----------------

## OPEN CLASSES.

## Class 129—DOGS (Large Size exceeding 30 lbs).

First Prize	... ..	£2 0 0
Second Prize	... ..	1 0 0
Third Prize	... ..	Diploma

## Class 130—BITCHES(exceeding 30 lbs).

First Prize	... ..	£2 0 0
Second Prize	... ..	1 0 0
Third Prize	... ..	Diploma

## Class 131—DOGS &amp; BITCHES. (not exceeding 30 lbs.)

First Prize	... ..	£2 0 0
Second Prize	... ..	1 0 0
Third Prize	... ..	Diploma

## NOVICE CLASS.

## Class 132—DOGS &amp; BITCHES.

First Prize	... ..	£2 0 0
Second Prize	... ..	0 10 0
Third Prize	... ..	Diploma

## PUPPY CLASS.

## Class 133—DOGS &amp; BITCHES.

First Prize	... ..	£2 0 0
Second Prize	... ..	0 10 0
Third Prize	... ..	Diploma

## BRACE CLASS.

## Class 134.

Prize	... ..	Society's Medal.
-------	--------	------------------

## LOCAL CLASS.

Any Weight.

## Class 135—DOG OR BITCH.

First Prize	... ..	£2 0 0
Second Prize	... ..	0 10 0
Third Prize	... ..	Diploma

**BLACK AND TAN TERRIERS.**

FOR SPECIALS SEE PAGE 7.

**CHALLENGE CLASS.**

**Class 136—DOGS & BITCHES.**  
Prize ... .. Society's Medal

**OPEN CLASSES.**

**Class 137—DOGS & BITCHES.**  
(over 16 lbs.)

First Prize ... .. £2 0 0  
Second Prize ... .. 1 0 0  
Third Prize ... .. 0 10 0  
Fourth Prize ... .. Diploma

**Class 138—DOGS & BITCHES.**  
(over 6 lbs. and under 16 lbs.)

First Prize ... .. £2 0 0  
Second Prize ... .. 1 0 0  
Third Prize ... .. Diploma

**NOVICE CLASS.**

Any Weight over six lbs.

**Class 139—DOGS & BITCHES.**

First Prize ... .. £2 0 0  
Second Prize ... .. 1 0 0  
Third Prize ... .. 0 10 0  
Fourth Prize ... .. Diploma

**PUPPY CLASS.**

**Class 140—DOGS & BITCHES.**

First Prize ... .. £2 0 0  
Second Prize ... .. 0 10 0  
Third Prize ... .. Diploma

**BRACE CLASS.**

Class 141.

First Prize ... .. Society's Medal  
Second Prize ... .. Diploma

**UNCROPPED CLASS.**

(Any Weight).

**Class 142—DOGS & BITCHES.**  
Prize ... .. Gold Medal

**BLACK AND TAN TOYS.**  
Weight not to exceed 6 lbs.

**CHALLENGE CLASS.**

**Class 143—DOGS OR BITCHES.**  
First Prize ... .. Silver Medal  
Second Prize ... .. Diploma

**OPEN CLASSES.****Class 144—DOGS.**

First Prize ... .. £2 0 0  
Second Prize ... .. 0 10 0  
Third Prize ... .. Diploma

**Class 145—BITCHES.**

First Prize ... .. £2 0 0  
Second Prize ... .. 0 10 0  
Third Prize ... .. Diploma

**LOCAL CLASSES.**

Any Weight.

**CHALLENGE CLASS.**

**Class 146—DOGS OR BITCHES.**  
Prize... .. Silver Medal

**OPEN CLASS.**

**Class 147—DOGS OR BITCHES.**  
Any Weight.

First Prize ... .. £2 0 0  
Second Prize ... .. 0 15 0  
Third Prize ... .. 0 10 0  
Fourth Prize ... .. Diploma

**ENGLISH SMOOTH-HAIRED TERRIERS.**

FOR SPECIALS SEE PAGE 7.

(Except Black and Tan).

**Class 148—DOGS & BITCHES.**

First Prize ... .. £2 0 0  
Second Prize ... .. 0 10 0  
Third Prize ... .. Diploma

**YORKSHIRE TERRIERS.**

FOR SPECIALS SEE PAGE 7.

**CHALLENGE CLASS.**

**Class 149—DOGS & BITCHES.**  
Prize ... .. Silver Medal

**OPEN CLASSES.**

**Class 150—DOGS & BITCHES.**  
(under 6 lbs.)

First Prize ... .. £2 0 0  
Second Prize ... .. 0 10 0  
Third Prize ... .. Diploma

**Class 151—DOGS & BITCHES.**  
(over 6 lbs.)

First Prize ... .. £2 0 0  
Second Prize ... .. 0 10 0  
Third Prize ... .. Diploma

**NOVICE CLASS.**

Any Weight.

**Class 152—DOGS & BITCHES.**

First Prize ... .. £1 10 0  
Second Prize ... .. 0 10 0  
Third Prize ... .. Diploma

**Class 153—STUD DOGS.**

Prize presented by the Y.T.C.

**LOCAL CLASSES.**

**Class 154—DOGS or BITCHES.**  
(over 6 lbs.)

First Prize ... .. £2 0 0  
Second Prize ... .. 0 10 0  
Third Prize ... .. Diploma

**Class 155—DOGS or BITCHES.**  
(under 6 lbs.)

First Prize ... .. £2 0 0  
Second Prize ... .. 0 10 0  
Third Prize ... .. Diploma

**NOVICE CLASS.**

Class 156.—Any Weight.

First Prize ... .. £1 0 0  
Second Prize ... .. 0 10 0  
Third Prize ... .. Diploma

**Class 157.—BRACE CLASS.**

Prize ... .. Silver Medal

**SCHIPPERKES.****Class 158—DOGS.**

First Prize ... .. £1 10 0  
Second Prize ... .. 1 0 0  
Third Prize ... .. Diploma

**Class 159—BITCHES.**

First Prize ... .. £1 10 0  
Second Prize ... .. 1 0 0  
Third Prize ... .. Diploma

**PRIZE MEDAL CALCUTTA EXHIBITION.****BRECKNELL'S SADDLE SOAP.**

Used in the Royal Stables, by Her Majesty's Cavalry, and in Hunting Establishments.

The Best Thing Made for Cleaning Saddles.

**BRECKNELL, TURNER & SONS,**

(TO HER MAJESTY),

HAYMARKET, LONDON.

**FOR ANY VARIETY OF ROUGH - COATED TERRIER (EXCEPT FOX TERRIER).****Class 160—DOGS & BITCHES.**

First Prize ... .. £2 0 0  
Second Prize ... .. 1 0 0  
Third Prize ... .. 0 10 0

**SELLING CLASSES.**

**Class 161—FOR FOX TERRIERS.**

Price not to exceed £10.

First Prize ... .. £1 0 0  
Second Prize ... .. 0 10 0  
Third Prize ... .. Diploma

**Class 162—ANY OTHER BREED OF TERRIER.**

Price not to exceed £10.

First Prize ... .. £1 0 0  
Second Prize ... .. 0 10 0  
Third Prize ... .. Diploma

**Class 163—ANY BREED OF TERRIER.**

Price not to exceed £5.

First Prize ... .. Silver Medal  
Second Prize ... .. Bronze Medal  
Third Prize ... .. Diploma

**Class 164.****AUCTION CLASS.****FOR ANY VARIETY OF TERRIER.**

Each Dog in this Class will be put up to Auction on the third day of the Show at One o'clock, and if unsold will be returned.

Entries for this Class can be received any time prior to sale. The fee is 5/- per dog if made before the Show opens, after that time 7/6 each.

# LIST OF SHOWS

Registered in or for the Kennel Club Stud Books within the last Ten Years.

ARMAGH .. .. .	1888	LONDON (Aqua. Dachshunds) .. .. .	1887
BERGAVENNY .. .. .	1885	LONDON (Agricultural Hall) .. .. .	1888
BOSTON (Brit. K. Association) .. .. .	1883	LONDON (Aqua. Kennel Club) .. .. .	1886
BANGOR .. .. .	1887, 1888	LONDON (Barn Elms Kennel Club) .. .. .	1887, 1888
BARNSTAPLE .. .. .	1883, 1884, 1885	LONDON (C.P.) .. .. .	1878, 1880, 1881, 1883 to 1887
BATH (Bulldog) .. .. .	1888	LONDON (C.P. Bulldog) .. .. .	1884, 1885
BATTERSEA (F.T.) .. .. .	1883	LONDON (Humphrey's Hall Bulldog) .. .. .	1883
BELFAST .. .. .	1870, 1880, 1882, 1883, 1884	LONDON (Lillie Bridge F.T.) .. .. .	1882
BIDEFORD .. .. .	1883	LONDON (Knightbridge F.T.) .. .. .	1884
BIRKENHEAD .. .. .	1885, 1886, 1887, 1888	LONDON (Rough Club, Great Danes) .. .. .	1885
BIRMINGHAM .. .. .	1881, 1885, 1886, 1887, 1888	LONDON (Olympia) .. .. .	1887
BIRMINGHAM (Mid. F.T.) .. .. .	1886, 1888	LONDON (People's Palace) .. .. .	1888
BLACKPOOL (Fylde F.T.) .. .. .	1882, 1884	LONG MELFORD .. .. .	1885
BLAYDON-ON-TYNE .. .. .	1878, 1879	LOUTH .. .. .	1885
BOURNEMOUTH .. .. .	1882, 1885	MACCLESFIELD .. .. .	1881
BRAINTREE .. .. .	1882	MALDEN .. .. .	1881, 1882, 1884, 1886
BRENTWOOD .. .. .	1886	MANCHESTER (Drill Hall) .. .. .	1880
BRIDGEMOUTH .. .. .	1880, 1881, 1888	MANCHESTER (F.T.) .. .. .	1884
BRIDPORT .. .. .	1883	MANCHESTER .. .. .	1886, 1888, 1889
BRIGHTON .. .. .	1879, 1885, 1886, 1887, 1888	MANNINGTREE .. .. .	1880
BRIGHTON (Southdown F.T.) .. .. .	1882 to 1886	MARCH .. .. .	1884
BRISTOL .. .. .	1882 and 1884, 1885, 1886	MARGATE .. .. .	1880, 1881, 1882, 1884
BURY ST. EDMUNDS .. .. .	1887	MARKET DRAYTON .. .. .	1887
BURTON-ON-TRENT .. .. .	1881	MEATH .. .. .	1885
BUXTON .. .. .	1883, 1884	MERTHYR-TYDVIL .. .. .	1884
CAMBRIDGE .. .. .	1886, 1887	NEWCASTLE-ON-TYNE .. .. .	1887
CARDIFF .. .. .	1884, 1887	NEWPORT (Mon.) .. .. .	1886, 1887, 1888
CARLISLE .. .. .	1887	NORWICH .. .. .	1882, 1886, 1887
CARNARVON .. .. .	1885, 1886	OMAGH .. .. .	1883
CHELMSFORD .. .. .	1887	OXFORD (F.T. Club) .. .. .	1881, 1882, 1883, 1885-86
CHELTENHAM .. .. .	1884	PEMBROKE .. .. .	1884
CHESTERFIELD .. .. .	1878 to 1887, 1888	PERTH .. .. .	1879
CINDERFORD .. .. .	1884	PLYMOUTH .. .. .	1882, 1883, 1885
CIRENCESTER .. .. .	1882, 1883, 1886, 1887	PORTADOWN .. .. .	1882
COLCHESTER .. .. .	1882, 1883	PORTSMOUTH .. .. .	1887
CORK .. .. .	1886, 1887, 1888	POULTON LE FYLDE (F.T.) .. .. .	1884
CREDITON .. .. .	1881	PRESTON (Fylde F.T.C.) .. .. .	1883, 1885
DARLINGTON 1879 to 1880, & 1884 to 1887, 1888		PULBOROUGH (F.T.) .. .. .	1884, 1885
DARLINGTON (F.T.) .. .. .	1881 to 1887	RETFORD .. .. .	1881
DERBY .. .. .	1885	RICHMOND .. .. .	1888
DOVER .. .. .	1886, 1888	RYDE .. .. .	1885, 1886, 1887, 1888
DORCHESTER .. .. .	1884, 1885	SAFFRON WALDEN .. .. .	1884
DUBLIN (Ex. F.) .. .. .	1879, 1880 and 1883	SCARBOROUGH .. .. .	1886, 1887
DUBLIN (Zoological Gardens) .. .. .	1884, 1885, 1886	SHEFFIELD .. .. .	1882, 1883
DUBLIN (Irish Terriers) .. .. .	1887	SHEFFIELD & HALLAM (F.T.) .. .. .	1885, 1886, 1887, 1888
DUMFRIES .. .. .	1887	SHEFFIELD (Brit. K. Association) .. .. .	1885
DUDLEY .. .. .	1882, 1887	SHERBORNE (F.T.) .. .. .	1885, 1886
EASTBOURNE .. .. .	1881	SHREWSBURY (F.T.) .. .. .	1885, 1886, 1887
EBBW VALE .. .. .	1888	SIBNAL .. .. .	1888
EDINBURGH (SCOTTISH K.C.) .. .. .	1885, 1886, 1887, 1888	SOUTHAMPTON .. .. .	1888
EDINBURGH (Scotch Met.) .. .. .	1884	SOUTHPORT .. .. .	1886
EXETER .. .. .	1879, 1884	STALYBRIDGE .. .. .	(2) 1886
FARNWORTH .. .. .	1880, 1883 to 1886	STOCKPORT .. .. .	1884
FROME .. .. .	1881, 1883 to 1886	STOCKTON-ON-TEES .. .. .	1888
GLASGOW .. .. .	1885, 1887-1888	STOCKTON-ON-TEES (F.T.) .. .. .	1885, 1886
GLoucester .. .. .	1883-1888	STONE .. .. .	1884
GLOUCESTER (F.T.) .. .. .	1884	STRABANE .. .. .	1882 to 1887, 1888
GREENOCK .. .. .	1881, 1883, 1884	STRATFORD-ON-AVON .. .. .	1880
GUILDFORD (F.T.) .. .. .	1884	STREATHAM .. .. .	1886
HALIFAX .. .. .	1885, 1887	STROUD .. .. .	1884
HANLEY .. .. .	1883, 1885, 1886, 1887	SUNDERLAND .. .. .	1883
HASTINGS (Southdown Fox T.C.) .. .. .	1883	SWANSEA .. .. .	1882
HAVERINGHILL .. .. .	1879	SWINDON .. .. .	1880, 1883, 1884, 1885
HAY, BRECON .. .. .	1887	TAMWORTH .. .. .	1884, 1885
HENLEY-ON-THAMES .. .. .	1883, 1884	TENBY .. .. .	1884
HERTFORD .. .. .	1882, 1883	TORQUAY .. .. .	1882
HULL .. .. .	1884 to 1887	TROWBRIDGE, WILTS AND W. COUNTIES .. .. .	1887
ILFORD .. .. .	1888	TUNBRIDGE WELLS .. .. .	1884, 1886
IPSWICH .. .. .	1882 to 1887	WALTHAM ABBEY .. .. .	1885
KENDAL .. .. .	1880	WARE .. .. .	1886, 1887
KETERING .. .. .	1885	WARE (F.T.) .. .. .	1883 to 1888
KNIGHTON .. .. .	1885	WARWICK .. .. .	1884 to 1886
LANCASTER .. .. .	1888	WELLINGBOROUGH .. .. .	1884 to 1886
LANCASTER (F.T. Club) .. .. .	1887	WELLINGTON .. .. .	1885
LANCSTER .. .. .	1882	WELSHPOOL .. .. .	1883
LIMERICK .. .. .	1887	WEYMOUTH .. .. .	1885
LINCOLN .. .. .	1884	WEST BROMWICH .. .. .	1884 to 1886
LIVERPOOL .. .. .	1883, 1885, 1886, 1887, 1888, 1889	WEYMOUTH .. .. .	1885
LANELY .. .. .	1884	WHITEHAVEN .. .. .	1886
LONDON (Aldridge's Bulldog) .. .. .	1880	WIGAN .. .. .	1879
LONDON (A.P.) .. .. .	1879, 1881, 1882	WISHAW .. .. .	1887
LONDON (A.P. Bulldog) .. .. .	1879, 1882, 1883	WOLVERHAMPTON .. .. .	1879 to 1880, 1882, 1883, 1885
LONDON (Aqua. Collie) .. .. .	1885, 1886, 1888, 1889	WOLVERHAMPTON (F.T.) .. .. .	1883
LONDON (Aqua. Bulldog) .. .. .	1885, 1886, 1887	WOODBRIDGE .. .. .	1881
LONDON (Aqua. Pug dogs) .. .. .	1885, 1886, 1887	YORK .. .. .	1883, 1884
LONDON (Aqua. Toys) .. .. .	1885, 1886, 1887, 1888	YORK (F.T.) .. .. .	1885, 1886, 1887, 1888
LONDON (Aqua. Toy Span) .. .. .	1885, 1886, 1887, 1888		
LONDON (Aqua. Terrier) .. .. .	1886, 1888		

1.—Every dog exhibited at a show under Kennel Club Rules, must, except only those entered in local classes, previous to the time of entry for such show, be entered in a registry of names kept by the Kennel Club at their offices, 6, Cleveland Row, St. James, London, S.W. A charge of one shilling each dog will be made for registration. A name that has been already assumed and duly registered in the Kennel Club Registry, or entered in any published number of the Kennel Club Calendar, or Stud Book, by the owner of a dog of the same breed, cannot be registered except by a distinguishing name or number. If the name of a dog be changed, or an old name be reassumed, such name shall be required to be registered previous to the time of entry.

2.—Dogs that are already entered in any published number of the Kennel Club Calendar and Stud Book are exempt from the above rule, provided their names remain unchanged. Puppies exhibited in classes exclusively for litters of puppies are also exempt.

3.—Any dog which is to be exhibited at a show held under Kennel Club Rules must be the bona fide property of the exhibitor in whose name he is entered, and must have so been 14 clear days before the first day of the show. Each dog must, on the entry form, be clearly identified by name, by date of birth, and by the names of his sire and dam, and of the breeder, each and every of them, if known (as registered in accordance with Rule 1); and if the dam was covered by more than one dog the names of all must be given. If the age, pedigree, or breeder's name be not known, the dog must be entered at each show as breeder, age, or pedigree unknown, any or all, as the case may be.

4.—The bona fide owner of the dam at the time she whelps shall be considered to be the breeder of the litter. In cases, however, where a bitch is lent for breeding purposes, the person to whom the bitch is lent shall be considered the breeder of all puppies born during the period of such loan, provided he or she before the litter is born send to the Secretary of the Kennel Club a statement of the facts, signed by himself or herself and the owner of the bitch.

5.—If the name of a dog which has won a prize has been changed, it is necessary in entering the said dog to give his old name as well as his new name every time he is exhibited until the change has been duly published in the annual number of the Kennel Club Calendar and Stud Book, and if his name be changed again all his names must be repeated for a like period.

6.—If a dog should be entered as before directed by Rules 1, 2, 3, 4, and 5, he shall forfeit any prize that may have been awarded him; and if the omission be detected in time, he shall not be allowed to compete, and shall in either case forfeit all entrance fees and subscriptions.

7.—The committee or authorities of any show may reserve to themselves the right of refusing any entries they may think fit to exclude.

8.—A castrated dog, or spayed bitch shall be disqualified from competing, or from receiving a prize if awarded.

9.—Total blindness shall absolutely disqualify; partial blindness shall have great weight against a dog. Should a dog appear to be deaf or lame it shall be in the power of the judge to disqualify, unless he is satisfied that such defects are temporary.

10.—No dog shall be qualified to compete who shall be declared by the duly qualified and appointed veterinary inspector during the show to exhibit any form of contagious or infectious disease, neither shall such dog be entitled, if in that condition, to receive a prize if awarded, unless the committee shall consider that the owner of the dog was not to blame in the matter. The veterinary inspector shall give his decision in writing, duly signed, to the secretary or committee of the show before its close, and such opinion shall be final as regards the condition of the dog.

11.—If any prize-winner is disqualified, the next dog in order of merit as placed by the judge shall take his position, and the win shall count in every respect the same as if it had been the original award. An equal (challenge), or first prize shall be counted as a win to both dogs.

12.—Any person who is proved to the satisfaction of the Committee of the Kennel Club to have been guilty of any fraudulent or discreditable conduct in connection with dogs, dog shows, or field trials, may, in addition to any pecuniary penalty to which he may be liable, be declared incapable of competing for or winning a prize at any show or field trials held under the Kennel Club rules for such period as the committee of the Kennel Club may decide upon.

13.—In estimating the number of prizes a dog has won, with reference to whether it should compete in a (challenge) class or not, the number of prizes won shall be calculated up to 12 p.m. of the day previous to the original day of closing entries for the show.

14.—A dog that has been exhibited or has won a prize in a class exclusively for puppies under twelve months old on the first day of the show is not thereby excluded from being exhibited in a class where previous prize winners are not allowed to compete.

15.—The committee of the Kennel Club shall publish as early as possible in the year in *The Kennel Gazette* a list of shows selected by them as being worthy to rank as first class exhibitions. A first prize at any one of such shows shall for purposes of a challenge class qualification count two points. A first prize at any other show under Kennel Club Rules shall count one point. No dog shall be qualified to compete in a challenge class that has won less than six points at shows registered in or for the Kennel Club Calendar and Stud Books; and no dog shall compete in an open class that is qualified to compete in a challenge class at any show where challenge classes are provided for that breed. The prizes must be won in open classes, which are open to all dogs of any breed without restriction, or in varieties of the same breed divided by weight, colour, sex, or age in adult classes.

16.—No dog shall in future be entitled to be called a champion that has not scored six points in challenge classes, two of which must be either at the Kennel Club Shows or at the shows of the National Dog Show Society, Birmingham. Each win in a challenge class at a first class show (as explained in Rule 15) shall count two points, and each win in a challenge class at other shows under Kennel Club Rules one point.

N.B. to Rules 15 to 16: These Rules shall come into operation upon January 1, 1889, and any dog which shall have qualified previous to that date for competition in a champion class or challenge class must compete in a challenge class where such class is provided. Any dog entitled to be called a champion before that date shall not be deprived of his title.

17.—If any dog be disqualified by the judge, or formally objected to during the show for being improperly tampered with, the veterinary inspector shall examine the dog, and give his opinion to the secretary in writing before the close of the show.

18.—An objection to a dog may be made by any person; it must be made to the secretary of the show at any time within fourteen days from the last day of the show. The objection must be in writing, and the objector must, unless in cases where the objection is laid by the Committee of the Kennel Club, or by the regularly constituted committee of the show (in which case a deposit shall not be necessary), at the same time lodge a sum of £1 in the hands of the secretary, which deposit shall, if the objection is proved to be frivolous to the satisfaction of the committee of the Kennel Club, be forfeited. Such objection must be brought by the secretary before his committee, if possible within fourteen days of the objection being lodged; and any person concerned shall have due notice from the secretary of the show of the meeting, and an opportunity of making any statement which they may desire relevant to the case. The said committee shall decide the case, but under any circumstances an appeal shall lie to the committee of the Kennel Club.

19.—The term "foreign dog" (for exhibition purposes) shall not include any dog for which a separate class is provided in the Kennel Club Register of Names or in the schedule.

20.—In the above rules the word "dog" shall be interpreted to include both sexes.

### THE "CANINE" SURGERY.

65, HIGH STREET, MARYLEBONE, W.

(Adjoining the Old Church.)

**M**R. JAMES ROWE, M.R.C.V.S., makes the TREATMENT of the DISEASES & INJURIES of DOGS and CATS a speciality, and has spacious Asphalted Kennels for such Animals if required.

Consultation fee, 2s. 6d. ; Entrance Fee, 2s. 6d.

Letters of Advice, 3s. 6d. ; with prescription, 7s.

Visit within 1 mile or under 2 miles, 5s.

2 miles 10s. 6d., single visit, or 3 visits for a Guinea.

Night visits, 21s. Dogs' Nails Cut, 2s. 6d.

Teeth Cleaned, Scraped, or Extracted, 10s. 6d.

Vaccination, 10s. 6d.

Hours of Consultation, between 8 and 10 a.m., and from 2 to 6 p.m.

Telegrams promptly responded to.

N.B.—The Sale of Dogs is respectfully declined.

# BOULTON & PAUL, MANUFACTURERS, NORWICH,

No. 104, RANGE OF LEAN-TO KENNELS.

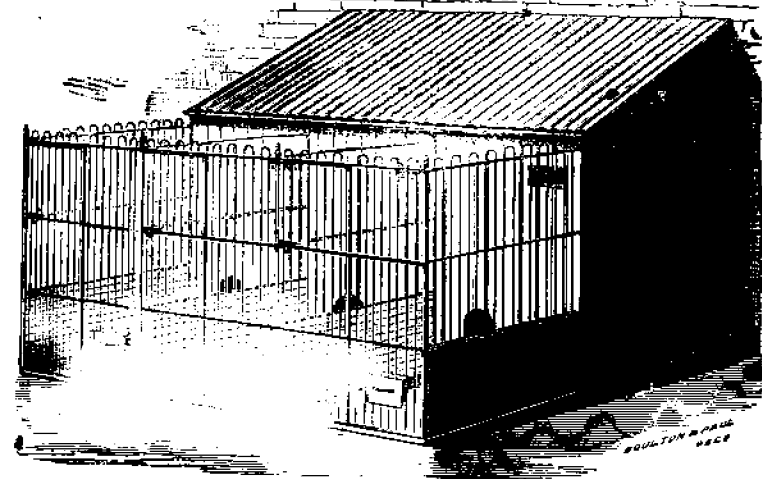

*Registered Copyright*

With passage 2 ft. 6 in. wide at the back, to fix against a wall; height to eaves, 6 ft.; at back, 7 ft. 6 in. Each Kennel is 4 ft. by 4 ft., and has a yard 6 ft. by 4 ft., fitted with a Registered folding day and night bench, and a wood batten floor in kennel, revolving feeding trough in yard.

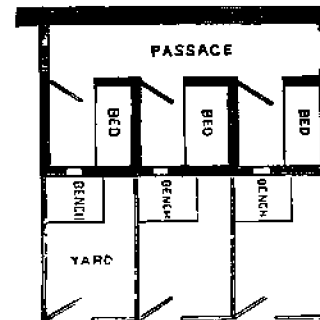

Plan of Kennel No. 104.

#### Cash Prices, Carriage Paid.

1 Kennel and Yard ... ..	£6 10 0
2 " " " " " " " "	12 0 0
3 " " " " " " " "	17 10 0

Wood Batten Floors for Yards, 12s. each.

Testimonials received from every country.

From J. C. GILMORE, Esq., Bristol.

The Dog's House and Enclosures have been now up some little time, and I am every pleased with them. Every one who has seen them agrees with me that they have never seen a better thing of the kind.

Every Requisite for the Kennel, Poultry Yard, Pheasantry, Aviary, &c.,  
Manufactured by Ourselves. Send for Latest Catalogues.

## BOULTON & PAUL, Manufacturers, NORWICH

# PLATER'S

## VENTILATED

# Dog Hampers

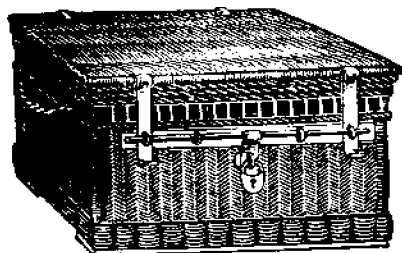

Secured with improved Iron Hinges and Fittings, as supplied to the Government for Post Office Baskets.

FOR PARTICULARS OF SIZES AND PRICES APPLY TO

## JOHN J. PLATER,

*Poultry and Dog Hamper Works,*

### 262, 263, & 264, BRADFORD STREET

### Birmingham.

—: PRICE LISTS POST FREE. :—

"The most suitable package exhibited at the Birmingham Dog Show was, we thought, a Wicker Basket, manufactured by Mr. PLATER, of Birmingham. Our reason for preferring the Wicker Case is that there is no fear of suffocation, which is the chief thing to be considered in the conveyance of Dogs by rail"—  
*Live Stock Journal.*

## HENRY'S

### GREAT INDIAN REMEDIES.

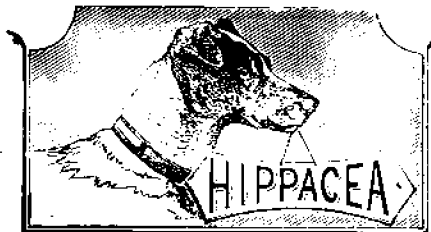

### THE KENNEL REQUISITE.

Clarence House, Barnes, S.W., January 2nd, 1889.

SIR,—Some months ago I had a most gratifying experience of "*Hippacea*" as a dressing for eczema, the worst case I have ever seen in a St. Bernard. The coat had almost entirely fallen off, and the dog presented a truly pitiable appearance. Regular dressing with "*Hippacea*" applied with a plentiful supply of elbow grease soon effected a wonderful change in the state of the skin, the hair began to sprout at once, and the dog's coat is now one of the best in the fancy.

This case cost me exactly seven and six, so that although the prime cost of "*Hippacea*" is somewhat large I fancy it is in the long run the cheapest preparation in the market; and in addition it has the great advantage for the owner who is his own kennelman of being a cleanly and agreeable dressing.

I also used "*Hippacea*" alone as a dressing for a bad scald, which entirely removed the hair and skin in two or three places. Result a complete cure, the hair returning its nature colour.

"*Hippacea*" has proved of signal use in the house for sore throats and on on, and there is always a small tin in the nursery.

I regret to say that another of my St. Bernards has eczema badly, so that I shall be obliged by your sending me a 10s. tin of "*Hippacea*," together with a 5s. box of "*Hippacea Pills*," which I have found of service as an alternative.

W. P. STRANGWAYS.

# HIPPACEA PILLS

### PURIFY THE BLOOD WITHOUT PURGING.

Newton Hall, Newton-le-Willows, 28th November, 1888.

DEAR SIR,—I can with great confidence recommend "*Hippacea Pills*" for conditioning, grossness, and scratching caused by the feeding being too stimulating; as in every case I have tried them, the effect has been most satisfactory. I find I am very nearly out, so send me another 5s. box. R. HOOD WRIGHT.

Prices of "*Hippacea*" Post Free, 2/9, 5/3, & 10/3 per Tin.

Prices of "*Hippacea Pills*," 1/-, 2/6, & 5/- per box.

HENRY'S GREAT INDIAN REMEDIES LIMITED  
43, KING WILLIAM ST LONDON E.C. & MADRAS, INDIA.  
F.M. BOWDEN - MANAGING DIRECTOR.

**J. A. Restall,**  
2½, ST. MARTIN'S PLACE, OFF BROAD STREET,  
**BIRMINGHAM.**

MANUFACTURER OF  
Medals, Badges, &c., for Agricultural  
Horticultural, Cattle, Pigeon, Dog,  
Poultry, &c., Shows.

MANUFACTURER OF  
Silver, Silver-Plated, and Oak  
Cups, for Champion-ship Meetings,  
&c.  
The Cheapest Largest, and most  
varied Stock in the Trade.

Apply for Illustrated Catalogue of Medals, Cups, and Presentation  
Articles.



Patent Dies Prepared, and Medals struck for Special Clubs,  
Exhibitions, &c.  
Special Terms offered to Clubs adapting their own Dies.

SPECIALITY:—

Solid Silver Hall, marked Cups from 7,6 per oz. upwards.

*THE KENNEL*  
**Pedigree Books**

These will be a series of Stud Books, each (except in some instances) being devoted to one breed.

THE Pedigree of every dog registered is traced to its source, as far as that can be ascertained by the most painstaking research, thus making these Pedigree Books reliable and exhaustive, whilst the simplicity of the form of registration adopted enables the most inexperienced to identify any dog, and to trace its descent.

After the first issue, it is intended to publish a Supplement to the Stud Book of each breed separately—records of prizes won will be included.

The price of the Pedigree Books will be moderate, varying from 1s. upwards according to the amount of matter each volume contains.

**The Fox-Terrier Stud Book**

Will be published very shortly (delay has occurred through the illness of the editor). Entries can still be received. Registration fee for non-winners, 2s. 6d. each; three or more, the property of the same owner, 2s. each.

**The St. Bernard Stud Book**

In course of completion, and will be published very soon.

**The Collie Stud Book.**

This volume of the

**KENNEL PEDIGREE BOOKS**

Is also considerably advanced, and will be published without delay. Pedigree Books of other breeds will rapidly follow.

The REGISTRATION FEE will be the same in respect to all breeds, and it is requested that entries be forwarded as early as possible to the Editor, HUGH DALZIC WOKING, Author of "British Dogs," "Monographs on the Greyhound," "The Collie," "The St. Bernard," "The Fox-Terrier, &c.," "Diseases of Dogs," "Dog Training, &c."

**THE PEDIGREE BOOKS AFFORD THE BEST POSSIBLE  
MEDIUM FOR ADVERTISEMENTS OF STUD DOGS.**

# Mappin & Webb's

ARE THE

BEST

FOR

HARD

WEAR



SPOONS

—AND—

FORKS

Catalogues  
Free.

Oxford Street, W., 158 to 162, }  
Poultry, E.C., 18 to 22, } LONDON.

MANUFACTORIES :—

SHEFFIELD : Royal Plate and Cutlery Works.

LONDON : 34, King's Street, Covent Garden, W.C.

Telegrams to—GILLARD KNIPTON.  
PORTERAGE 6d.

Postal Address—FRANK GILLARD,  
BELVOIR KENNELS, GRANTHAM.

Excellent Testimonials from all Parts of the Country.

## GILLARD'S COMPOUND,

For Distemper in Dogs. A Safe and Efficient Remedy.

Sold in Bottles 2/9 each ; three bottles 7/6 ; one dozen bottles 25/- Forwarded by post, on receipt of P.O.O., made payable at Grantham.

## GILLARD'S SPECIFIC,

SURE CURE FOR JAUNDICE IN DOGS,

(Commonly called Yellows),

Can be obtained in Bottles at 3s. each.

Copy of a letter received HIS GRACE THE DUKE OF RUTLAND, K.G.  
Belvoir Castle, April 9th, 1883.

Gillard, Huntsman to the Belvoir Hounds, has used his Compound in the Kennels for about ten years with the greatest success; and during that period has scarcely lost a Puppy from Distemper.

From Arthur Hargreaves, Esq., Park Cottage, Eccles, April 1st, 1884.  
Dear Sir, I now write to tell you of the wonderful cure your distemper Compound has effected in the case of my Fox Terrier Puppy, "Hognaston Relict." The dog was absolutely at death's door, and the Vet, whom I called in said he had never seen a worse case. The third day after I began to use the Compound the dog's appetite returned, and he took his food heartily; and before the week was out the fever left him, and the disease was killed, and in a fortnight the dog was perfectly well. I may add that I followed out implicitly your directions as to Diet, and keeping the eyes and nose clean. I have now no fear of Distemper, and don't think I shall ever lose another Puppy from that disease. Several of my friends whom I advised to try the Compound write me that they have not lost a single Puppy since they began to use it.

From T. P. Lewis, Esq., Llysnewydd, Llandyssill, South Wales, May 20th, 1883.  
Sir, I write you a line to tell you how very pleased I am with the Compound for Distemper you sent me. I have had four couples of my Harriers ill with Distemper (three couples of them being two of three season Hounds). I have followed your directions and have not lost one. I think it wonderful good stuff, and will recommend it most highly to all my friends.

From A. H. Clarke, Esq., 7, Western Terrace, The Park, Nottingham.  
I have used Gillard's Distemper Compound successfully amongst my Fox Terriers. One remarkable cure I made with it. My Fox Terrier Puppy "Result" took Distemper at Maidstone Show, on the 18th of June, and with the aid of the Compound I was able to exhibit him at the Crystal Palace Show, on July 1st, and in such condition that he took two First Prizes and three Cups, including the 50 Guinea Challenge Cup. I find that Puppies treated with this Compound are far less trouble, and are cured much quicker than with anything else I have used.

From J. Lee Rutled, Esq., Witheridge, N. Devon, August 30th, 1884.  
I am much pleased with both your Distemper Compound and Jaundice Specific: it is capital stuff. I have been a breeder of Pointers the last fifteen years, and before using your medicines had the bad luck to lose a large number, especially from Yellows, of which complaint four were ill when I received your Specific, and I am also glad to inform you three have recovered; the other died from an overdose. Should therefore advise all who use it to keep strictly to the directions, regulating the dose according to the age of the dog.

From R. J. Lloyd Price, Esq., Rhiwalas, Bala, North Wales, April 15th, 1887.  
I believe your Distemper Powders to be the best medicine extant for that disease.  
From the Honourable Geoffrey P. C. Hill, Bucknall, Shropshire, November 10th, 1880.  
I will never be without your Compound, as I am certain it is a real good thing for Distemper, and my Puppies are all getting round, though they had it very badly.

From Tom Furr, Huntsman, Quorn Kennels, Loughborough.  
I think your Compound a capital thing for Distemper, and being so easily given, there is no occasion to pull the patient about and upset it, which in some cases does so much harm.

From Sir Vincent M. Corbet, Action Reynolds, Shrewsbury.  
I should feel much obliged if you would send me three bottles of your Distemper Compound, and the same of the Jaundice Specific. I always used them when I had the Fox Hounds, and found them nearly a certain cure.

# FRANK GOODALL,

(For 16 Years Huntsman of Her Majesty's Staghounds),

CAN BE CONSULTED UPON ALL

## DISEASES OF THE DOG

**AT HIS SURGERY,**

**7, Warwick St., Cockspur St., S.W.,**

DAILY BETWEEN 11 A.M. AND 4 P.M.,

AND AT

**21, KILDARE GARDENS,**

WESTBOURNE GROVE,

In the Evening, or at any time or place by appointment.

**SPECIAL CURE FOR**

## DISTEMPER & JAUNDICE,

These Medicines can be had by Parcels Post, in  
Bottles 2s. 9d. each and upwards.

---

**Agent for Spratt's Patent, Limited.**

# SPRATTS PATENT MEAT "FIBRINE" VEGETABLE DOG CAKES

(WITH BEETROOT),

20s. per Cwt., Carriage Paid, Bags included.

To Avoid Imposition Please Note Stamp.

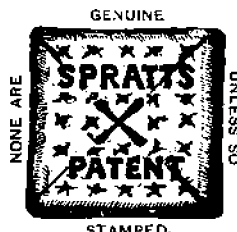

Can be obtained of all Grocers, Corn Dealers, &c.,  
in 7lb., 14lb., 28lb., and Cwt. Bags.

STAMPED WITH OUR NAME AND TRADE MARK, A. X.

*SPECIALITY FOR ST. BERNARDS.*

PATENT

FISH AND MEAT

FIBRINE DOG CAKES

(WITH BEETROOT).

Per 20s. Cwt., Bag included.

A light and easily-digested food for Dogs. In cases of DISTEMPER, ECZEMA, and other Diseases, they are especially valuable, as they are most readily eaten (in many cases being preferred to meat alone), and are a most successful food for DELICATE and DAINTY-FEEDING DOGS, and for preparing Dogs for EXHIBITION.

The abundance of natural phosphates they contain ensures their being a perfect food for young growing Puppies, particularly of a larger breed, such as St. Bernards, that have a tendency to rickets.

## HOUND MEAL,

18s. Per Cwt., Carriage Paid.

This meal is used in various kennels where Meal is preferred to Biscuits, and we shall be happy to send samples and furnish particulars. Every Bag bears our name and trade mark.

SPRATTS PATENT, LIMITED, LONDON, S.E.  
NEW YORK FACTORY—239-245, EAST 56th STREET.  
BERLIN FACTORY—LAGERHOF BRUNNENSTRASSE.

Manufactured also in ST. PETERSBURG (129, Obvodny Canal) by  
Spratts Patent (Russia Limited.)